

# Technical data sheet for Bench Top 900mm

BTLB8900-LS, BTLB8900-CD, BTLB8900-RB



BTLB8900-CD

## SPECIFICATIONS

### Dimensions

Width 900mm  
Depth 805mm  
Height 915mm  
Incl. low back 970mm  
Incl. splashback option 1130mm

### Nett weight

Leg Stand models 70kg  
Cabinet Base models 88kg  
Refrigerated Base models 116kg

### Packing data

#### Leg Stand models

0.54m<sup>3</sup>, 120kg  
Width 945mm  
Depth 870mm  
Height 665mm

#### Cabinet Base models

1.02m<sup>3</sup>, 153kg  
Width 945mm  
Depth 870mm  
Height 1260mm

#### Refrigerated Base models

1.02m<sup>3</sup>, 181kg  
Width 945mm  
Depth 870mm  
Height 1260mm

### Refrigerated Base

Type Ventilated system  
Refrigerant R134a (160grams)  
Climate classification T – tropical  
Electrical connection  
220-240Vac, 50Hz, 1.8A, 1P+N+E  
3 pin 10A plug cordset fitted

### OPTIONS AT EXTRA COST

Castors  
Plinth mounting

BTLB8900-LS

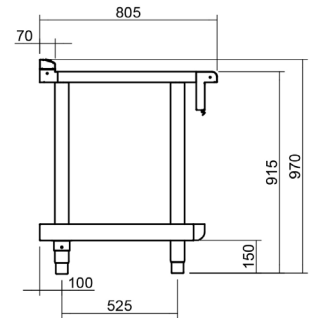
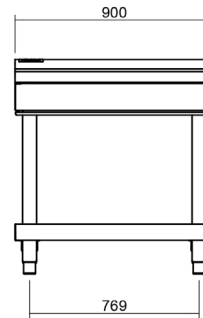

BTLB8900-CD

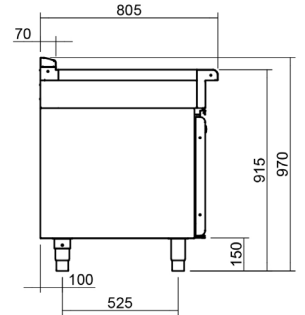
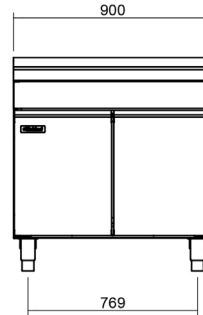

BTLB8900-RB

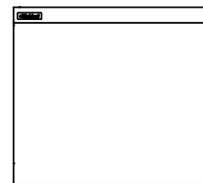
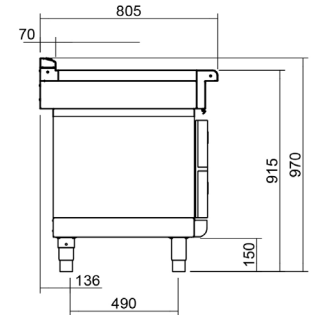
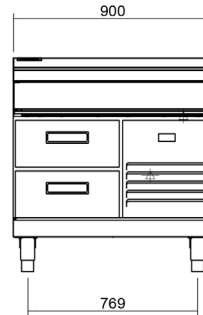

## Series Options

BTLB - Low back models  
BTB - 215mm splashback option



Australia [moffat.com.au](http://moffat.com.au)

New Zealand [moffat.co.nz](http://moffat.co.nz)

In line with policy to continually develop and improve its products, Moffat Limited reserves the right to change specifications and design without notice.



ISO9001  
Quality  
Management  
Standard

an Ali Group Company



The Spirit of Excellence