

Technical data sheet for

# Convotherm maxx pro easyDial Combi Steamer

## CXEBD10.20 ELECTRIC BOILER 22 x 1/1 GN or 11 x 2/1 GN



CXEBD10.20

- Boiler system
- Natural Smart Climate™ (ACS+) cooking methods: Steam, Combi-steam, Convection
- Natural Smart Climate™ extra functions:
  - Crisp&Tasty - 5 moisture removal settings
  - BakePro - 5 levels of traditional baking
  - HumidityPro - 5 humidity settings
  - Controllable fan - 5 speed settings
- easyDial: all functions are set on one operating level
- ConvoClean fully automatic cleaning system

### DIMENSIONS

|        |         |
|--------|---------|
| Width  | 1120 mm |
| Depth  | 992 mm  |
| Height | 1058 mm |
| Weight | 204 kg  |

### PACKED DIMENSIONS

|                                    |         |
|------------------------------------|---------|
| Width                              | 1345 mm |
| Depth                              | 1140 mm |
| Height                             | 1300 mm |
| Weight (including cleaning system) | 242 kg  |

### Safety clearances\*

|   |        |
|---|--------|
| Rear                                    | 50 mm  |
| Right                                   | 50 mm  |
| Left (larger recommended for servicing) | 50 mm  |
| Top (for ventilation)                   | 500 mm |

\*Heat sources must lie at a minimum distance of 500 mm from the appliance.

### INSTALLATION REQUIREMENTS

For precise installation instructions please refer to the units installation manual

### LOADING CAPACITY

|  |        |
|--|--------|
| Max. number of food containers                 |        |
| Shelf distance                                 | 68mm   |
| GN 1/1 (with standard rack)                    | 22     |
| GN 2/1 (with standard rack)                    | 11     |
| 600 x 400 baking sheet (with appropriate rack) | 16     |
| Max. loading weight GN 1/1 / 600 x 400         |        |
| Per combi steamer                              | 100 kg |
| Per shelf                                      | 15 kg  |

### ELECTRICAL SUPPLY

|  |   |
|--|---|
| 3N~ 400V 50/60Hz (3P+N+E)                                |   |
| Rated power consumption                                  | 33.7 kW   |
| Rated current  | 48.7 A  |
| Fuse   | 50 A  |
| RCD (GFCI), frequency converter                          | Type A (singlephase) (recommended), type B/F (optional) |
| Special voltage options available on request.            |   |
| Connection to an energy optimisation system as standard. |   |

### WATER CONNECTION

|                            |  |
|----------------------------|--|
| Water supply               | 2 x G 3/4" permanent connection, optionally including connecting pipe (min. DN13 / 1/2") |
| Flow pressure              | 150 - 600 kPa (1.5 - 6 bar)  |
| Appliance drain            |  |
| Drain version              | Permanent connection (recommended) or funnel waste trap                                  |
| Type                       | DN50 (min. internal Ø: 46 mm)  |
| Slope for waste-water pipe | min. 3.5% (2°)   |

### WATER QUALITY

|                              |  |
|------------------------------|--|
| Drinking water               |  |
| Total hardness               |  |
| Cleaning, recoil shower      | 4-20 °dh / 70 - 360 ppm / 7 - 35°TH / 5 - 25°e |
| Shower, boiler               |  |
| Properties                   |  |
| pH                           | 6.5 - 8.5                                      |
| Cl- (chloride)               | max. 60 mg/l                                   |
| Cl2 (free chlorine)          | max. 0.2 mg/l                                  |
| SO4 <sup>2-</sup> (sulphate) | max. 150 mg/l                                  |
| Fe (iron)                    | max. 0.1 mg/l                                  |
| Temperature                  | max. 40°C                                      |
| Electrical conductivity      | min. 20 µS/cm                                  |

### EMISSIONS

|                         |                     |
|-------------------------|---------------------|
| Heat output             |                     |
| Latent heat             | 4700 kJ/h / 1.31 kW |
| Sensible heat           | 5100 kJ/h / 1.42 kW |
| Waste water temperature | max. 80 °C          |
| Noise during operation  | max. 70 dBA         |

### STACKING KIT

|                        |  |
|------------------------|--|
| Permitted combinations | 6.20 on 10.20 (Electric on electric appliance) |
|------------------------|--|

Front view

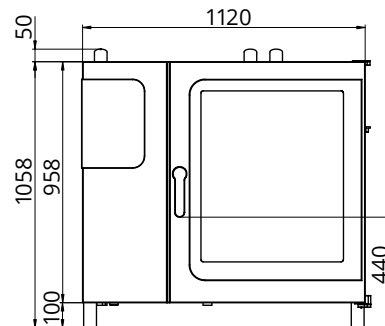

View from above with wall clearances

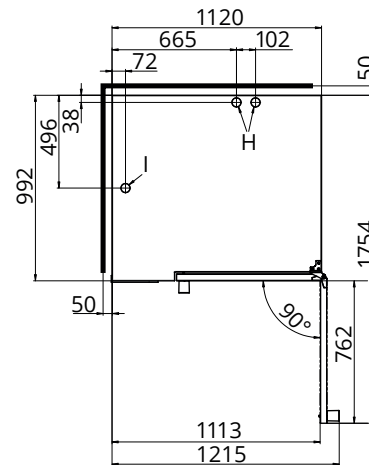

Connection points

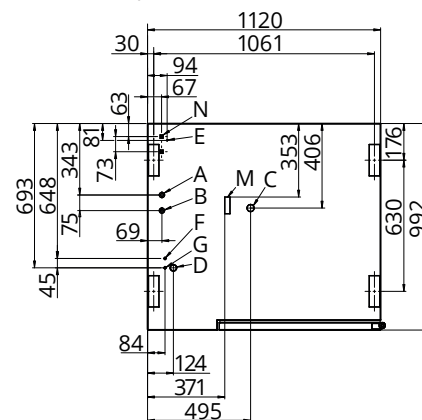

- A Water connection (for water injection)
- B Water connection (for cleaning, recoil hand shower)
- C Drain connection DN50
- D Electrical connection
- E Equipotential bonding
- F Rinse-aid connection
- G Cleaning-agent connection
- H Air vent Ø 50mm
- I Dry air intake Ø 50mm
- M Safety overflow 80mm x 25mm
- N RJ45 Ethernet port



Australia [moffat.com.au](http://moffat.com.au)

New Zealand [moffat.co.nz](http://moffat.co.nz)

In line with policy to continually develop and improve its products, Moffat Limited reserves the right to change specifications and design without notice.

an Ali Group Company



The Spirit of Excellence