

Technical data sheet for  
**ELECTRIC RANGE STATIC OVEN 900mm -  
 SOLID TOP**

E570



E570

E570

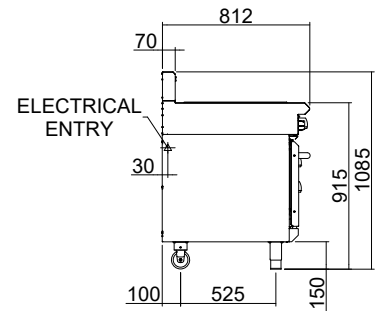
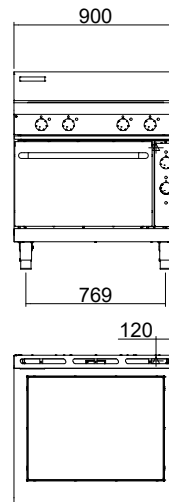

**SPECIFICATIONS**

**Cooktop**

16mm thick 16Mo3 steel hot plate  
 750mm x 520mm plate area.  
 Four 2.7kW radiant heating elements  
 under plate

**Oven**

4.5kW bottom heat element  
 2.0kW top heat element

**Electrical requirements**

E570 17.3 kW

**Electrical connection**

17.3 kW max  
 400-415Vac, 50/60Hz, 3P+N+E  
 L1 30.8A max  
 L2 22.4A max  
 L3 22.4A max

**Oven Dimensions**

Width 665mm  
 Depth 590mm  
 Height 400mm  
 Rack size 650mm x 600mm  
 Rack positions 4

**Dimensions**

Width 900mm  
 Depth 812mm  
 Height 915mm  
 Incl. splashback 1085mm

**Nett weight**

195kg

**Packing data**

1.03m<sup>3</sup>, 260kg  
 Width 945mm  
 Depth 870mm  
 Height 1255mm

**Options**

Adjustable feet at rear  
 Castors



Australia [moffat.com.au](http://moffat.com.au)  
 New Zealand [moffat.co.nz](http://moffat.co.nz)

In line with policy to continually develop and improve its products, Moffat Limited reserves the right to change specifications and design without notice.



an Ali Group Company



The Spirit of Excellence