

Technical data sheet for Twin Pan Electric Fryer 450mm

FNLB8224EE



FNLB8224EE

SPECIFICATIONS

Production rate

31kg/hr

Pan Size

Oil capacity 12L (24lbs shortening)
per pan

Width 175mm

Length 380mm

Oil frying depth 95mm

Baskets

2 chrome plated wire baskets
140mm W x 335mm D x 145mm H

Elements

3 x 2.83kW stainless steel heating
element per pan

Electrical requirements

17kW, 400-415Vac, 50/60hz,

3P+N+E

L1 23.6A

L2 23.6A

L3 23.6A

Electrical Connection

62mm from RH side, 365mm from
rear and 440mm from floor

Dimensions

Width 450mm

Depth 805mm

Height 915mm

Incl. low back 970mm

Incl. splashback option 1130mm

Nett weight

74kg nett

Packing data

0.54m³, 116kg

Width 870mm

Depth 495mm

Height 1255mm

OPTIONS AT EXTRA COST

Waldorf Filtamax filtration system

Extra baskets

Side splash guards

Joining caps

Castors

Plinth mounting

FNLB8224EE

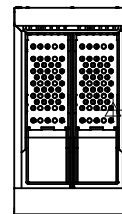
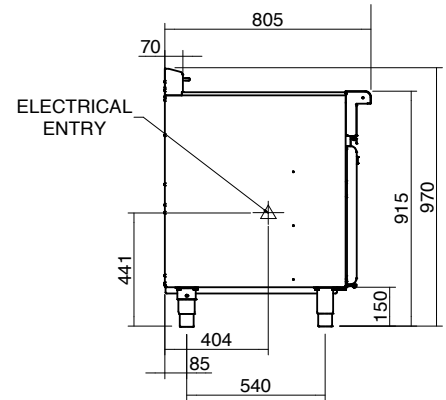
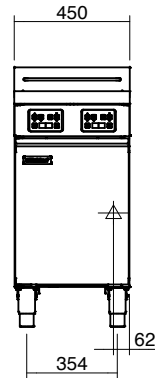

Series Options

FNLB - Low back models

FNB - 215mm splashback option



Australia moffat.com.au

New Zealand moffat.co.nz

In line with policy to continually develop and improve
its products, Moffat Limited reserves the right to
change specifications and design without notice.



ISO9001
Quality
Management
Standard

an Ali Group Company



The Spirit of Excellence