

Technical data sheet for Electric Griddle 600mm

GPLB8600E-B, GPLB8600E-LS, GPLB8600E-CD



GPLB8600E-CD

SPECIFICATIONS

Griddle

Elements
3 x 2.4kW stainless steel sheathed heating elements

Electrical requirements

7.2kW
230-240Vac, 50/60Hz, 1P+N+E, 30A

Plate

Cooking surface 592mm x 530mm,
3138cm²

Electrical connection

130mm from LH side, 32mm from rear, and 740mm from floor

Dimensions

Bench models

Width 600mm

Depth 805mm

Height 315mm

Incl. low back 370mm

Incl. splashback option 530mm

All models (excluding Bench model)

Width 600mm

Depth 805mm

Height 915mm

Incl. low back 970mm

Incl. splashback option 1130mm

Nett weight

Bench and Leg Stand models

118kg

Cabinet Base model

120kg

Packing data

Bench model

0.37m³, 170kg

Width 645mm

Depth 870mm

Height 665mm

All models (excluding Bench model)

0.70m³, 172kg

Width 645mm

Depth 870mm

Height 1255mm

OPTIONS AT EXTRA COST

Joining caps

Castors

Plinth mounting

Ribbed plate options

Chromed plate options

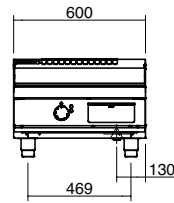

GPLB8600E-B

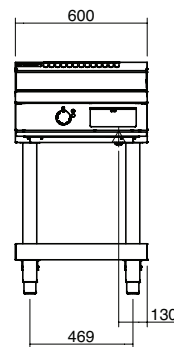
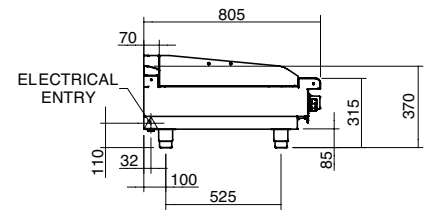

GPLB8600E-LS

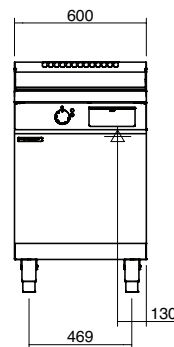
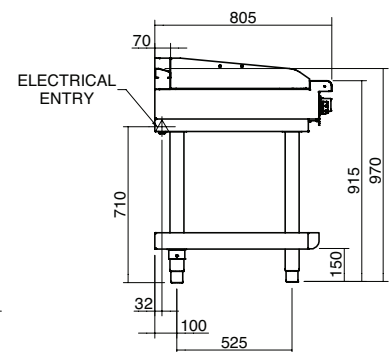

GPLB8600E-CD

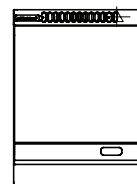
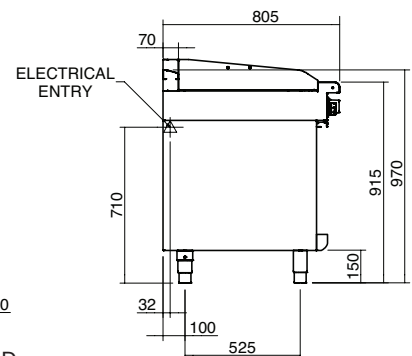

GPLB8600E

Series Options

GPLB - Low back models

GPB - 215mm splashback option



Australia moffat.com.au

New Zealand moffat.co.nz

In line with policy to continually develop and improve its products, Moffat Limited reserves the right to change specifications and design without notice.



ISO9001
Quality
Management
Standard

an Ali Group Company



The Spirit of Excellence