

Technical data sheet for Induction Cooktop 900mm - FULL AREA INDUCTION ZONE

INLB8400F-B, INLB8400F-LS, INLB8400F-CD



INLB8400F-CD

SPECIFICATIONS

Cooktop

4 x 5.0kW full area induction zones
270mm square induction zones

Electrical requirements

INLB8400F
20.0kW, 400-415V, 50/60Hz, 3P+E
28A / phase

Dimensions

Bench model
Width 900mm
Depth 805mm
Height 355mm
Incl. splashback 570mm
Incl. low back 410mm

All models (excluding Bench model)

Width 900mm
Depth 805mm
Height 915mm
Incl. splashback 1130mm
Incl. low back 970mm

Nett weight

105kg

Packing data

1.03m3, 157kg
Width 945mm
Depth 865mm
Height 1255mm

OPTIONS AT EXTRA COST

Castors
Plinth mounting

INLB8400F-B

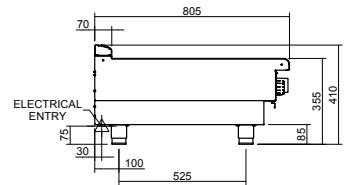
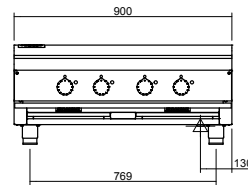

INLB8400F-LS

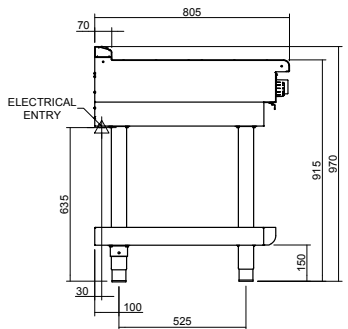
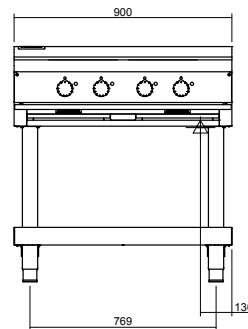

INLB8400F-CD

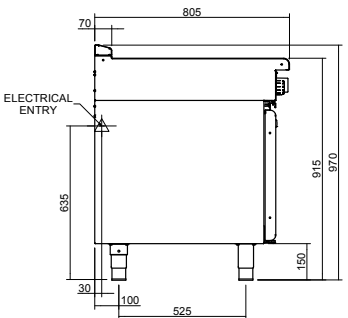
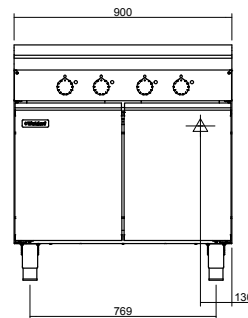

INLB8400F

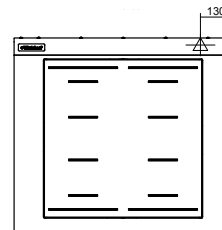

Series Options

INLB - Low back models
INB - 215mm splashback option



Australia moffat.com.au

New Zealand moffat.co.nz

In line with policy to continually develop and improve its products, Moffat Limited reserves the right to change specifications and design without notice.



ISO9001
Quality
Management
Standard

an Ali Group Company



The Spirit of Excellence