

# Technical data sheet for Induction Cooktop 900mm - ROUND INDUCTION ZONE

INLB8400R3-B, INLB8400R3-LS, INLB8400R3-CD, INLB8400R5-B, INLB8400R5-LS, INLB8400R5-CD

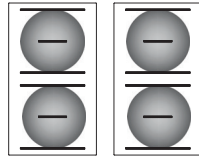

INLB8400R5-CD

## SPECIFICATIONS

### Cooktop

4 x 3.5kW induction zones  
or  
4 x 5kW induction zones  
Ø 270mm induction zones

### Electrical requirements

#### INLB8400R3

14.0kW, 400-415V, 50/60Hz, 3P+E  
20A / phase

#### INLB8400R5

20.0kW, 400-415V, 50/60Hz, 3P+E  
28A / phase

### Dimensions

#### Bench model

Width 900mm  
Depth 805mm  
Height 355mm  
Incl. splashback 570mm  
Incl. low back 410mm

#### All models (excluding Bench model)

Width 900mm  
Depth 805mm  
Height 915mm  
Incl. splashback 1130mm  
Incl. low back 970mm

### Induction Zone Options

R3 - 3.5kW round induction  
R5 - 5kW round induction

### Series Options

INLB - Low back models  
INB - 215mm splashback option

### Nett weight

105kg

### Packing data

1.03m<sup>3</sup>, 157kg  
Width 945mm  
Depth 865mm  
Height 1255mm

### OPTIONS AT EXTRA COST

Castors  
Plinth mounting

INLB8400R-B

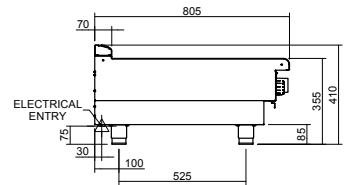
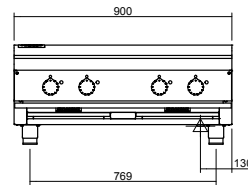

INLB8400R-LS

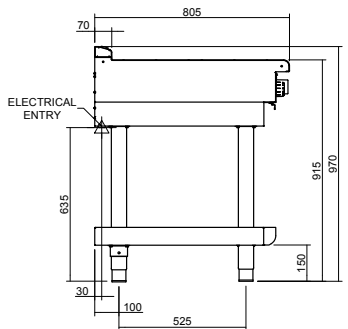
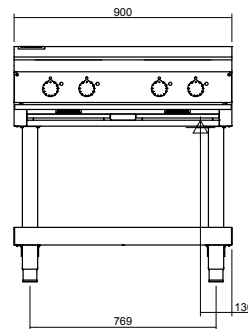

INLB8400R-CD

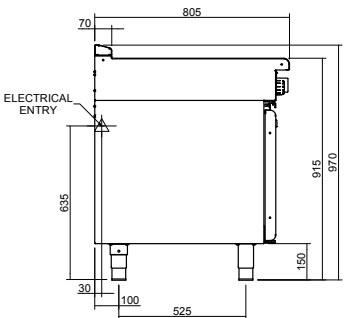
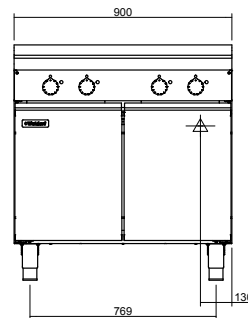

INLB8400R3 / INLB8400R5

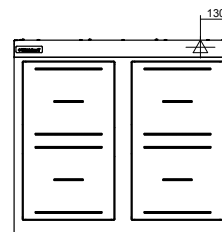

Australia [moffat.com.au](http://moffat.com.au)

New Zealand [moffat.co.nz](http://moffat.co.nz)

In line with policy to continually develop and improve its products, Moffat Limited reserves the right to change specifications and design without notice.



ISO9001  
Quality  
Management  
Standard

an Ali Group Company



The Spirit of Excellence