

# Technical data sheet for Electric Cooktops 900mm

RNLB8600E-B, RNLB8600E-LS, RNLB8600E-CD, RNLB8600E-RB



RNLB8600E-CD

## SPECIFICATIONS

### Cooktop

2.4 kW Open Radiant elements  
2.0 kW Hot Plate elements  
3.6 kW Griddle elements  
(per 300mm griddle section)

### Griddle Plate

300mm Griddle cooking surface  
292mm x 475mm, 1387cm<sup>2</sup>  
600mm Griddle cooking surface  
592mm x 475mm, 2812cm<sup>2</sup>  
900mm Griddle cooking surface  
892mm x 475mm, 4237cm<sup>2</sup>

### Electrical requirements

#### RNLB8600E

14.4 kW, 400-415Vac, 50/60hz,  
3P+N+E, 20A/phase

#### RNLB8603E

13.2 kW, 400-415Vac, 50/60hz,  
3P+N+E, 20A/phase max.

#### RNLB8606E

12 kW, 400-415Vac, 50/60hz, 3P+N+E,  
20A/phase max.

#### RNLB8609E

10.8 kW, 400-415Vac, 50/60hz,  
3P+N+E, 15A/phase max.

### Electrical connection

130mm from RH side, 31mm from rear  
85mm from bench height on bench  
models, 740mm from floor on leg  
stand and cabinet base models

### Series Options

RNLB - Low back models  
RNB - 215mm splashback option



Australia [moffat.com.au](http://moffat.com.au)

New Zealand [moffat.co.nz](http://moffat.co.nz)

In line with policy to continually develop and improve  
its products, Moffat Limited reserves the right to  
change specifications and design without notice.

### Refrigerated base

Type Ventilated system  
Refrigerant R134a (160grams)  
Climate classification T – tropical  
Electrical connection  
220-240Vac, 50Hz, 1.8A, 1P+N+E  
3 pin 10A plug cordset fitted

### Dimensions

#### Bench models

Width 900mm  
Depth 805mm  
Height 315mm

Incl. low back 370mm

Incl. splashback option 530mm

#### All models (excluding Bench model)

Width 900mm

Depth 805mm

Height 915mm

Incl. low back 970mm

Incl. splashback option 1130mm

### Packing data

#### Bench and Leg Stand models

0.55m<sup>3</sup>, 135kg (90kg nett)

Width 945mm

Depth 870mm

Height 665mm

#### Cabinet Base and Refrigerated Base models

1.03m<sup>3</sup>, 195kg (130kg nett)

Width 945mm

Depth 870mm

Height 1255mm

### OPTIONS AT EXTRA COST

Hot Plate elements  
(replace individual open radiant  
elements)

Ribbed griddle plates

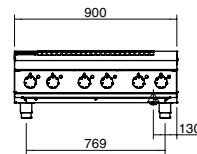

RNLB8600E-B

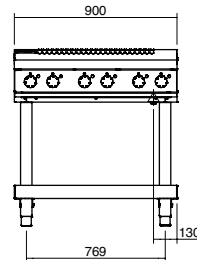

RNLB8600E-LS

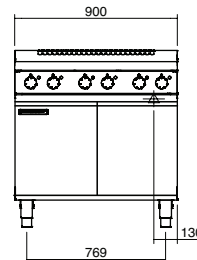

RNLB8600E-CD

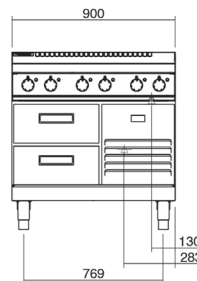

RNLB8600E-RB

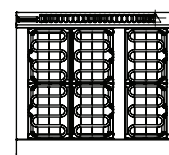
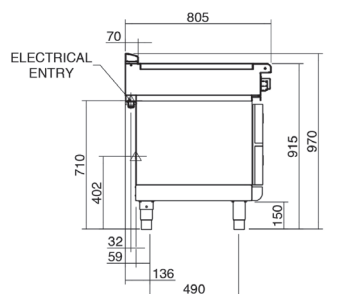
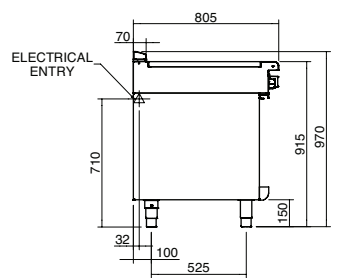
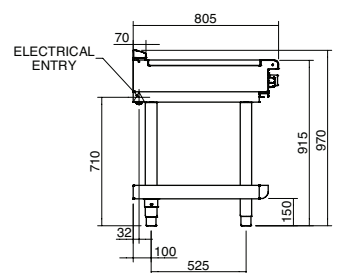
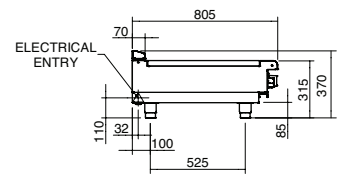

RNLB8600E

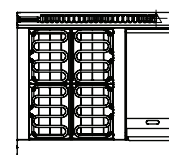

RNLB8603E

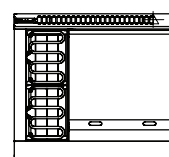

RNLB8606E

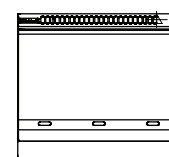

RNLB8609E



ISO9001  
Quality  
Management  
Standard

an Ali Group Company



The Spirit of Excellence