

# Technical data sheet for Gas Salamander 900mm

SNB8200G

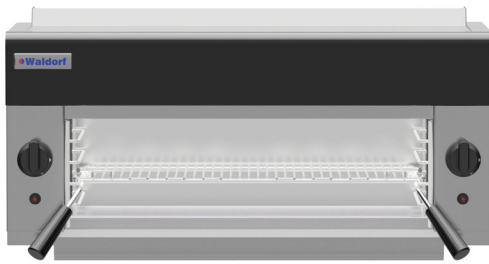

SNB8200G

SNB8200G

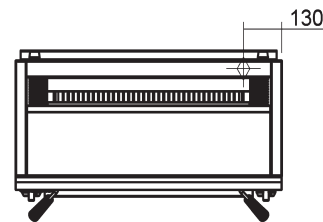
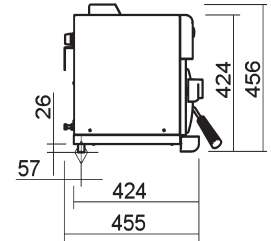
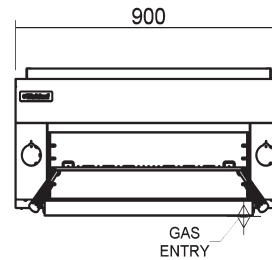

## SPECIFICATIONS

### Burners

2 x 15.5MJ/hr

### Gas power (gross)

31.5MJ/hr, 8.75kW

### Gas connection

R ½ BSP female, 130mm from right side, 25mm from rear

### Dimensions

Width 900mm

Depth 424mm

(455mm with wall mounting bracket)

Height 456mm

### Cooking area

Rack size 610mm x 310mm,  
1890cm<sup>2</sup>

Branding Plate 610mm x 310mm,  
1890cm<sup>2</sup>

### Nett weight

42kg

### Packing data

0.31m<sup>3</sup>, 69kg

Width 945mm

Depth 520mm

Height 635mm

### OPTIONS AT EXTRA COST

100mm high feet for bench mounting

Branding kit - includes one double-sided, ribbed cast aluminium branding plate



Australia [moffat.com.au](http://moffat.com.au)

New Zealand [moffat.co.nz](http://moffat.co.nz)

In line with policy to continually develop and improve its products, Moffat Limited reserves the right to change specifications and design without notice.



ISO9001  
Quality  
Management  
Standard

an Ali Group Company



The Spirit of Excellence