

*Autodrop*

**INSTRUCTION  
MANUAL**

**TRANSFER PUMP  
MODEL: PUMP1050**



**Tel: 1800 023 953**

**Fax: 03 9518 3833**

**Email: [vsales@moffat.com.au](mailto:vsales@moffat.com.au)**

**[www.moffat.com.au](http://www.moffat.com.au)**

---

# INDEX

INTRODUCTION / INDEX .....

DECLARATION OF CONFORMITY .....

IMPORTANT SAFETY INFORMATIONS .....

COMPRESSOR REQUIREMENTS .....

ASSEMBLY .....

USE .....

DISASSEMBLY .....

PREVENTIVE ROUTINE MAINTENANCE .....

TECHNICAL DETAILS ► PNEUMATIC SCHEME .....

3-D SCHEME SPARE PARTS IDENTIFICATION

- base of pump .....

- outlet .....

- Belpump-lift .....

- Belpump-vario .....

## IMPORTANT SAFETY INFORMATION

---

- Remove the air supply line ..... before attempting to clean, disassembly, or service the machine. (on/off button has to be OFF)

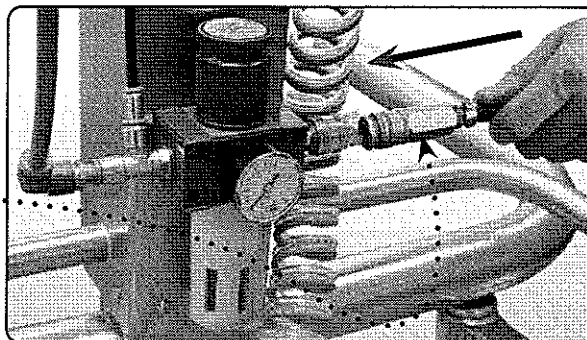

- ! KEEP FINGERS AND HANDS AWAY FROM MOVING PARTS AND DEPOSIT OUTLETS !!!



- Stand clear of the machine when lowering the hopper down to floor level (only for BELLIFT model).
- Do not service the Filter/Air regulator/Water dispenser with the air supply line connected. (on/off button has to be OFF)
- For servicing or technical support please contact BELDOS N.V./S.A. directly or one of it's authorized suppliers or dealers.
- Operating Air pressure should not be adjusted or exceed 7 Bar/101.5264 PSI.
- Always wash out the machine after use. Disassembly and lubricate all seals (As per cleaning instructions in this manual).
- Follow all instructions carefully within this manual before operating the machine for the first time.

## IMPORTANT

---

*All Stainless Steel parts are coated with a protective coating at the factory, and therefore any Stainless Steel parts that may come into contact with product must first be washed in hot water and detergent.*

---

## COMPRESSOR REQUIREMENTS

# IMPORTANT

*The compressed air supply must be run through a properly functioning air dryer before connecting to the air regulator on the machine.*

*Failure to comply will result in damage to the machine and the warranty will become null and void.*

Optimum performance is achieved with max. 7 BAR / 101.5264 PSI.

If not, check that the air supply to the machine is set to the correct pressure and not restricted by undersized fittings or hoses.

A minimum 3/8" I.D (10mm) air hose is required.

Otherwise the deposit speed will be reduced.

Typical compressor requirements: Minimum 2 horse power, capable of 4 C.F.M. @ 100 P.S.I.(7 Bar).

3 HP is the ideal size, as it will last many years longer.

Connect the air hose of your compressor to the quick connector on the Beldos machine beneath, next to the Filter/Air regulator/Water dispenser.

A **quick connector** .....  
for an air hose of Ø 8 mm (0.315")  
interioris also enclosed.

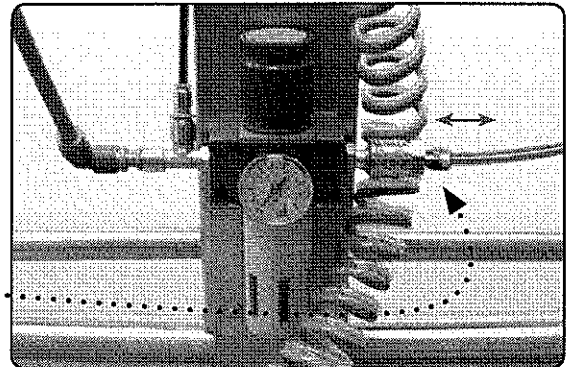

Pull up the turning button of the **air regulator** and adjust the desired pressure.

Turning button .....

Manometer .....

Water dispenser .....

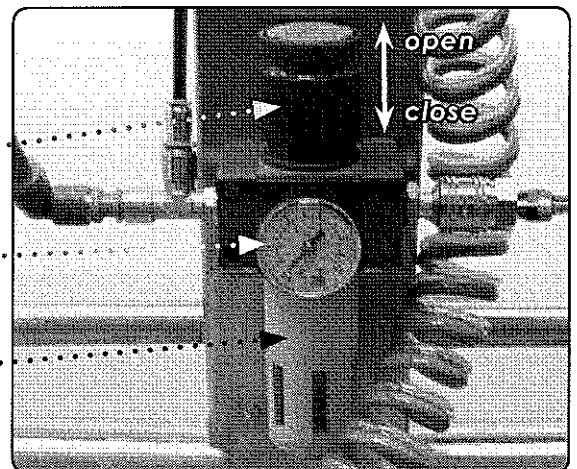

# TO UNPACK

Carefully remove all packing and safety material from the machine and machine parts.  
Keep all spare parts at a safe place nearby.  
The pump is sent in 3 parts : the frame, the hose, the base pump.

## A. ASSEMBLY

1

A. check all **seals**  
for wastage !!!



B. Lubricate them with  
**Beldos food**  
**approved grease.**

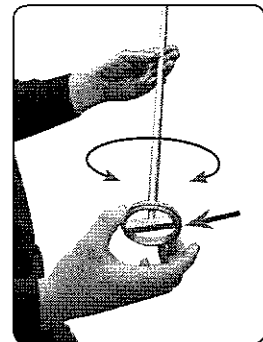
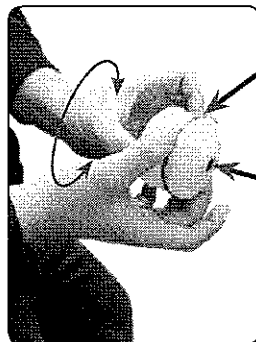

2

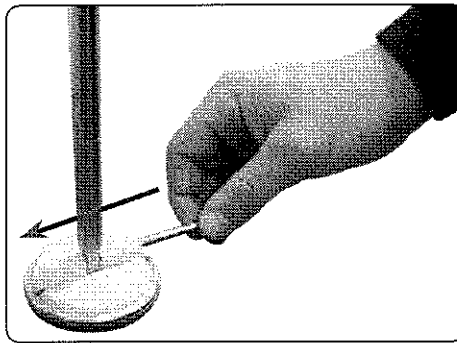
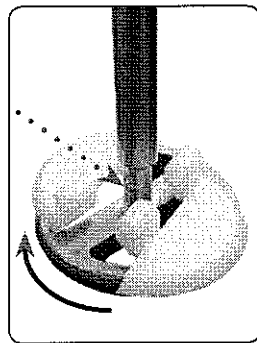
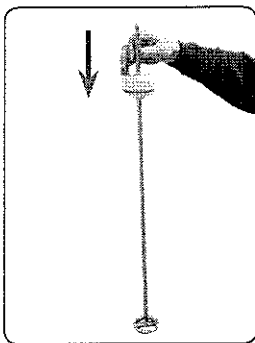

3

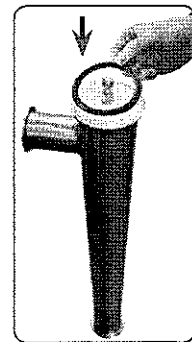
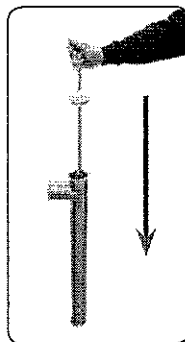
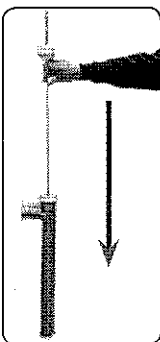

4

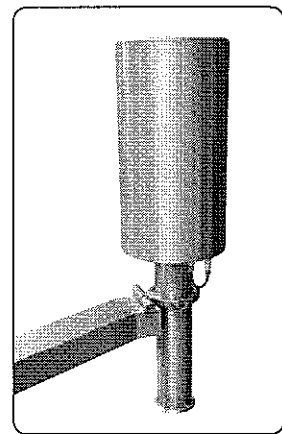
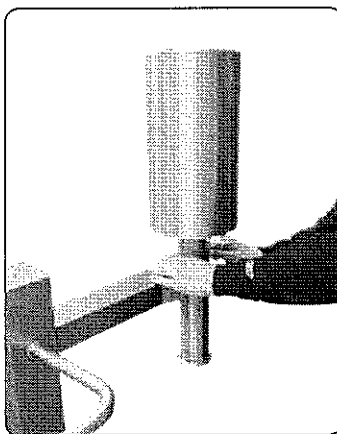
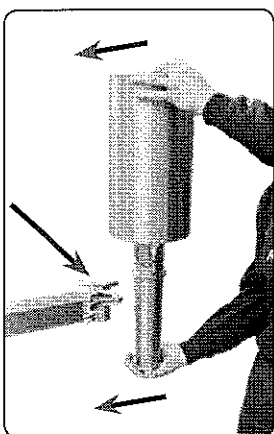

5

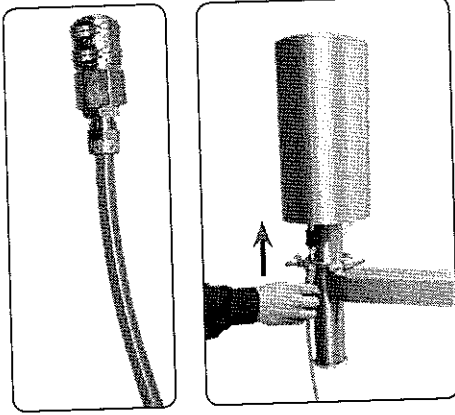

6

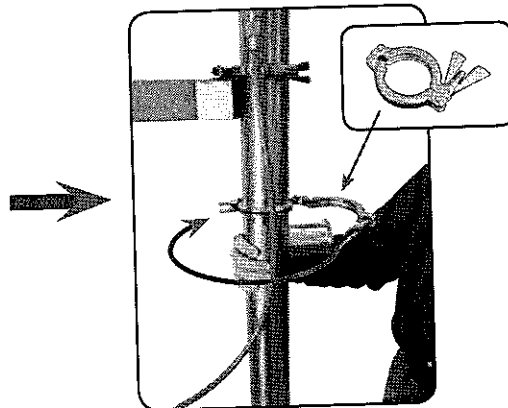
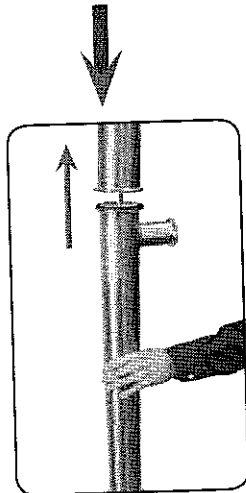
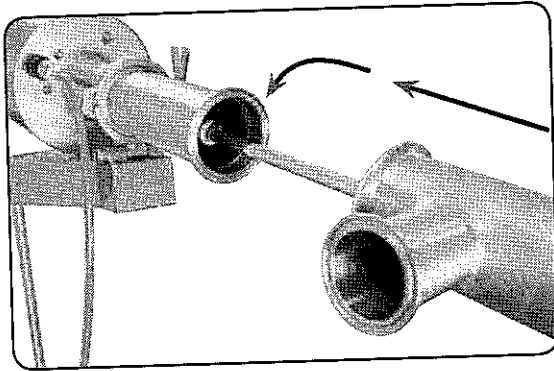
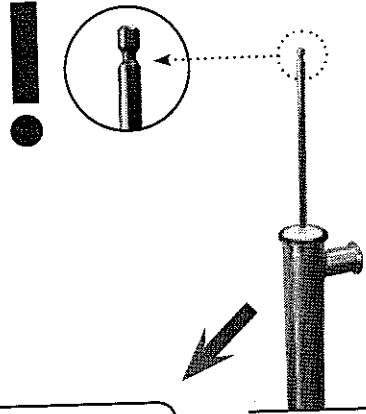
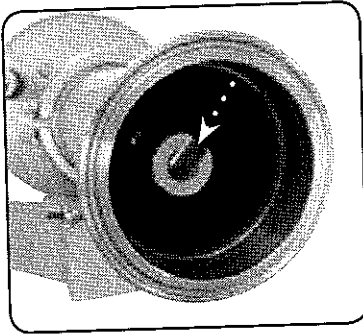

7

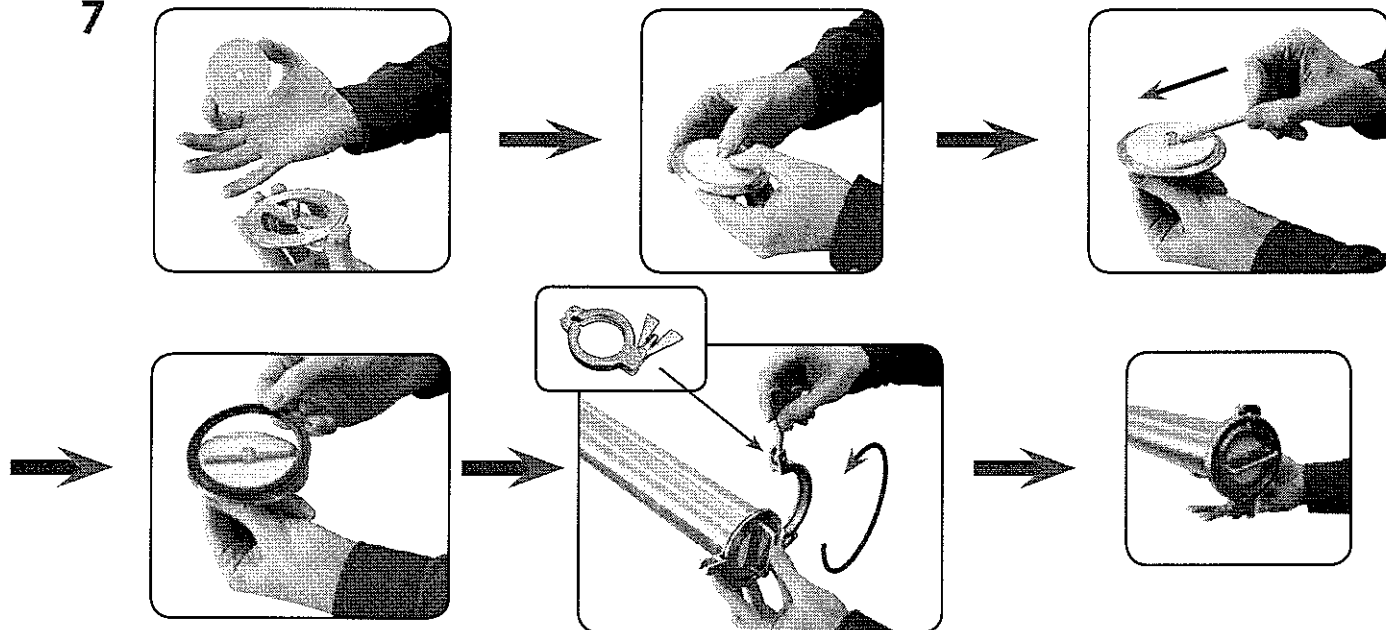

8

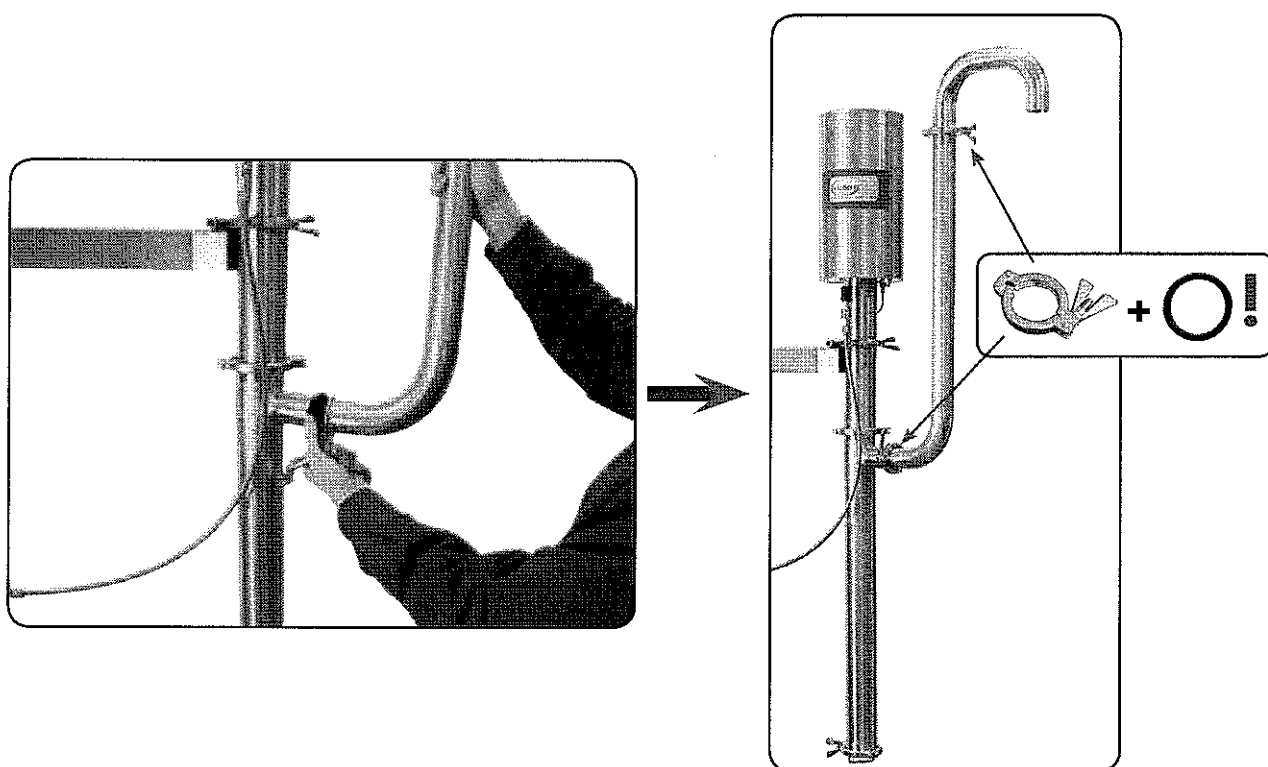

9

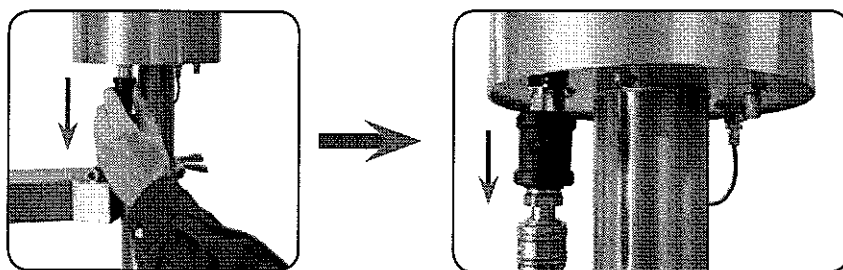

## B. USE

---

- 1 Check if all connections are safely fixed
- 

- 2 Bring the pump at the desired height  
With the pneumatic lever (Belpump-lift)  
Or the manual black lever (Blpump-vario)

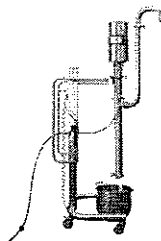

- 3 Put the bowl with your product  
Beneath the Belpump tube by turning  
It (turn over system)

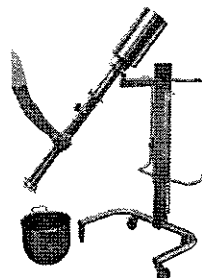

- 4 Connect the main air hose to the compressor
- 

### 5 Deposit Speed Control

**The speed control IN** regulates the speed with which the product is drawn into the product cylinder. Turn the button clockwise to accelerate, turn counter clockwise to slow down.

**The speed control OUT**

regulates the speed with which the product is pushed out of the product cylinder. Turn the button clockwise to accelerate, turn counter clockwise to slow down.

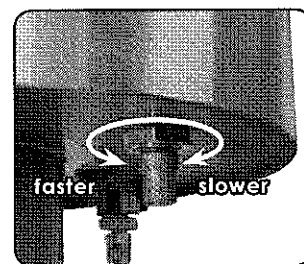

**For heavy products :**

slow down the speed for correct deposits

**For aerated products :**

slow down the speed for correct deposits and not to compress the products.

**IMPORTANT**

*If the speed is changed after the volume was set, this volume can change.  
Therefore always check the volume again after you modify the speed.*

---

### 6 Switching to another product

Before switching to another product, fill the bowl with hot water to clean the remaining products from the bowl.

When you see the clean water appearing from the pump, the new product can be poured in the bowl.



## C. DISASSEMBLY

- 1 Safety :  
put the depositor in  
the position "OFF"

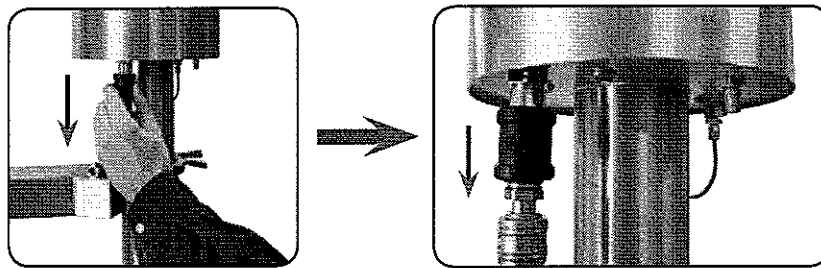

2

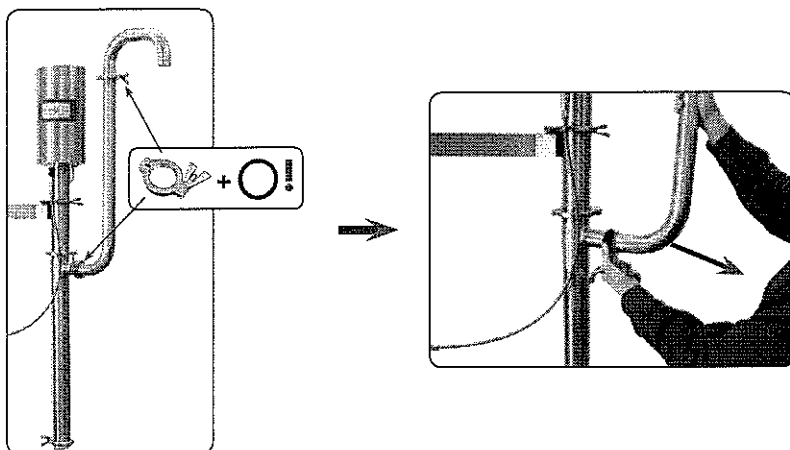

3

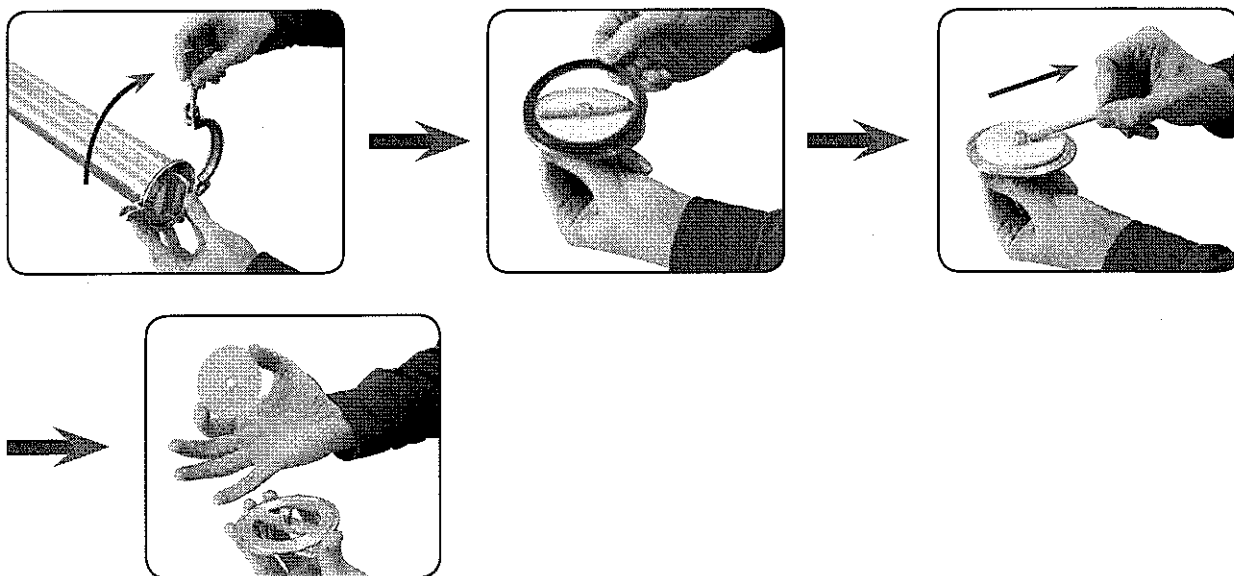

4

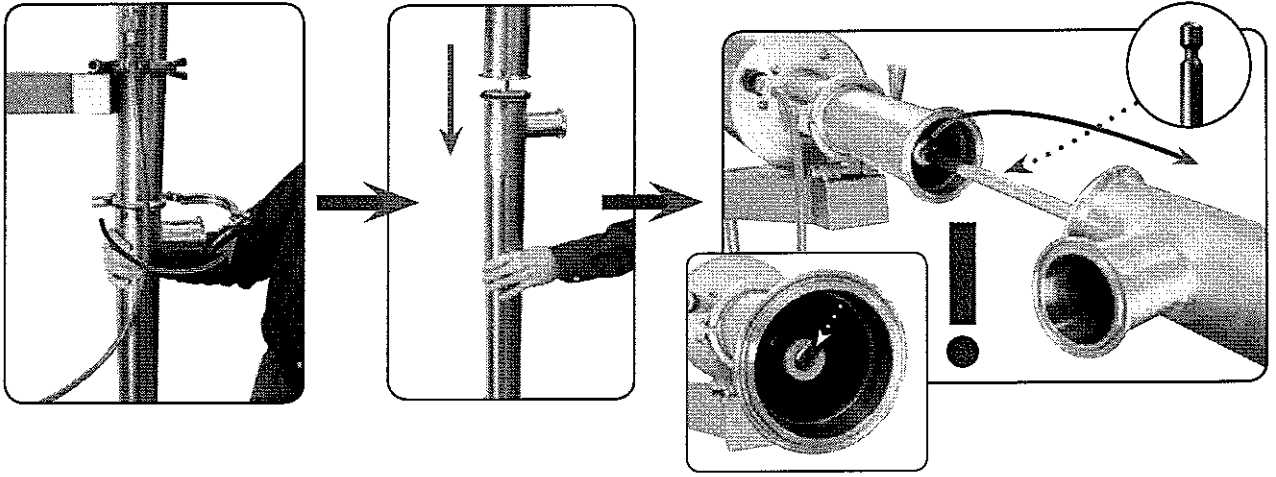

5

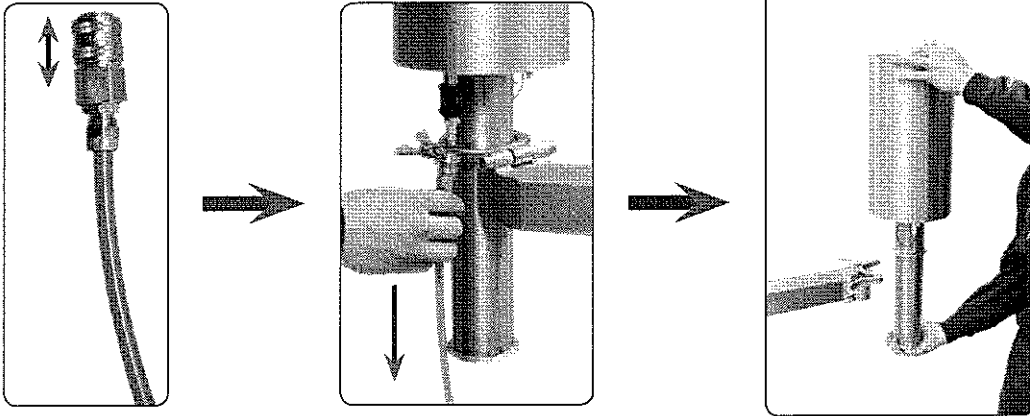

6

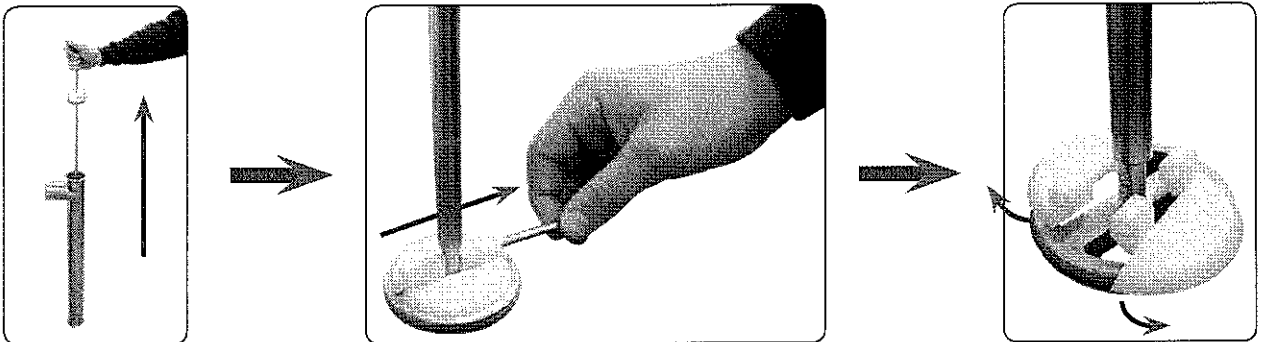

# PREVENTIVE ROUTINE MAINTENANCE

## 1 DAILY ROUTINE

Clean all parts with lukewarm water and soft detergent, dry them and control all **seals** on wastage and replace them when necessary. Grease them with the **Beldos food approved grease**.

We recommend to buy a complete **set of seals** as they are most important for the correct functioning of the machine.

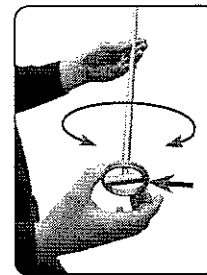
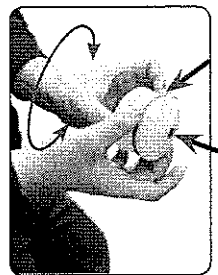

## 2 WEEKLY ROUTINE

1. Check the water of **the water dispenser** .. and if necessary clean the bowl and empty any accumulated water.

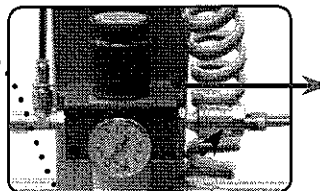

2. Check the water of the **air / water dispenser** .. and if necessary clean the bowl and empty any accumulated water. Turn the button a quarter to the left, now the water runs from the filter, turn the button with a quarter to the right to close.

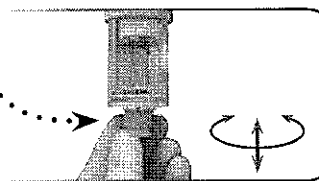

3. **Replace a worn out valve when needed.**  
To order the valves see page 14.

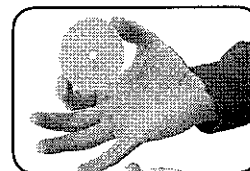

## 3 3-MONTHLY ROUTINE

1. Remove all seals from the pump
2. Remove the filter of the **air regulator /water dispenser** .....

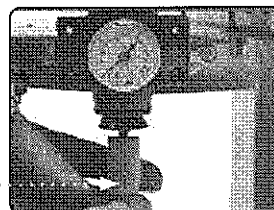

## 4 REMARK

**All seals** have to be removed from **the pistons, rotation cylinders, product cylinders, spouts/nozzles options** during cleaning in order to ensure full hygiene.

### A BELDOS - SEALS SPOON

is delivered with the machine for easy removal of the seals without damaging them.



▼ PISTON

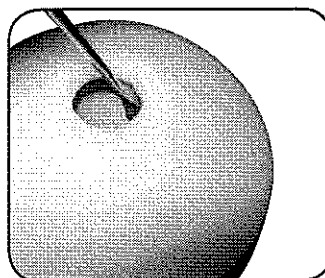

3-D SCHEME SPARE PART IDENTIFICATION

IT.	QTY	PART N°	ORDER FORM
1	1	004001035	
2	1	010029017	
3	1	003001030	
4	1	010029011	
5	1	010028012	
6	1	010001018	
7	1	010029015	
8	1	010004001	
9	2	010005001	
10	1	010008001	
11	2	010002007	

IT.	QTY	PART N°	ORDER FORM
1	1	010028003	
2	2	010001017	

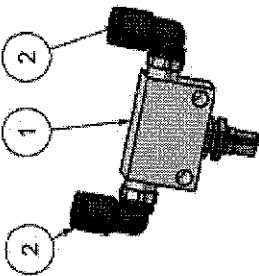

IT.	QTY	PART N°	ORDER FORM
1	1	010028004	
2	3	010001017	
3	2	010001003	
4	2	010026002	

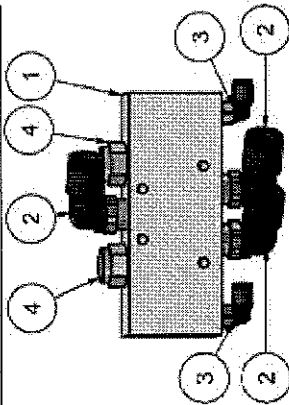

IT.	QTY	PART N°	ORDER FORM
1	1	005001056	
2	1	010000005	
3	2	010001017	
4	2	010017003	

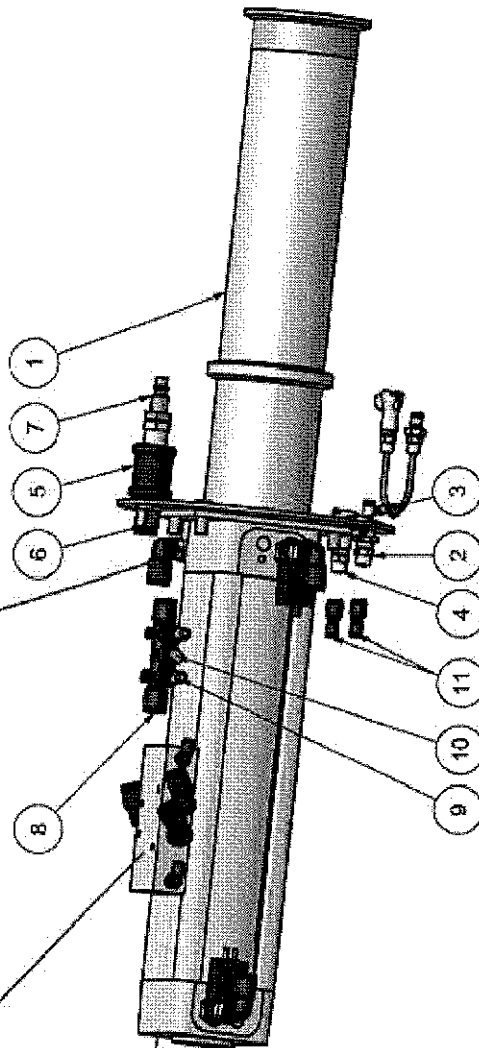
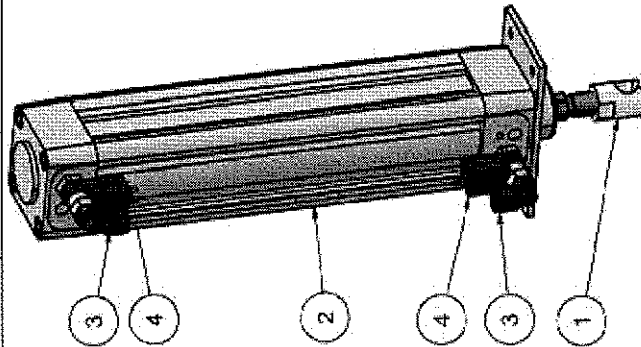

3-D SCHEME SPARE PART IDENTIFICATION OF OUTLET TUBE

IT.	QTY	PART N°	ORDER FORM
1	1	004001004	
2	2	005001016	
3	1	007018005	
4	1	008001014	

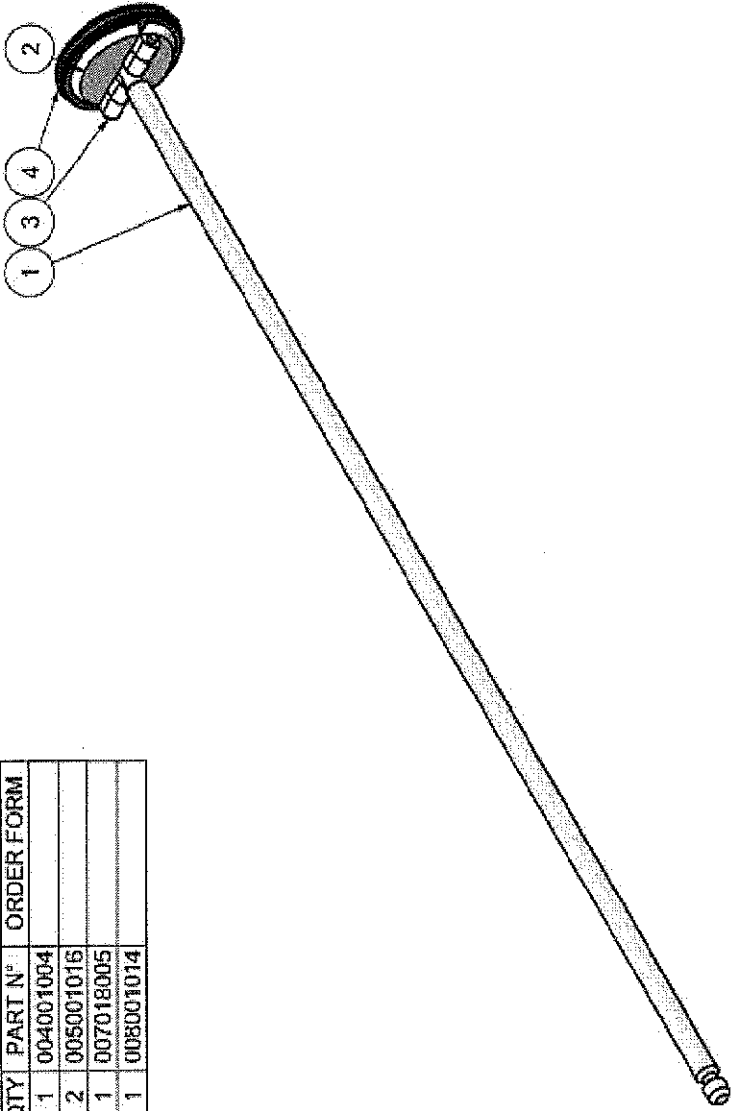

IT.	QTY	PART N°	ORDER FORM
1	1	004001123	
2	1	005001013	
3	1	007018005	

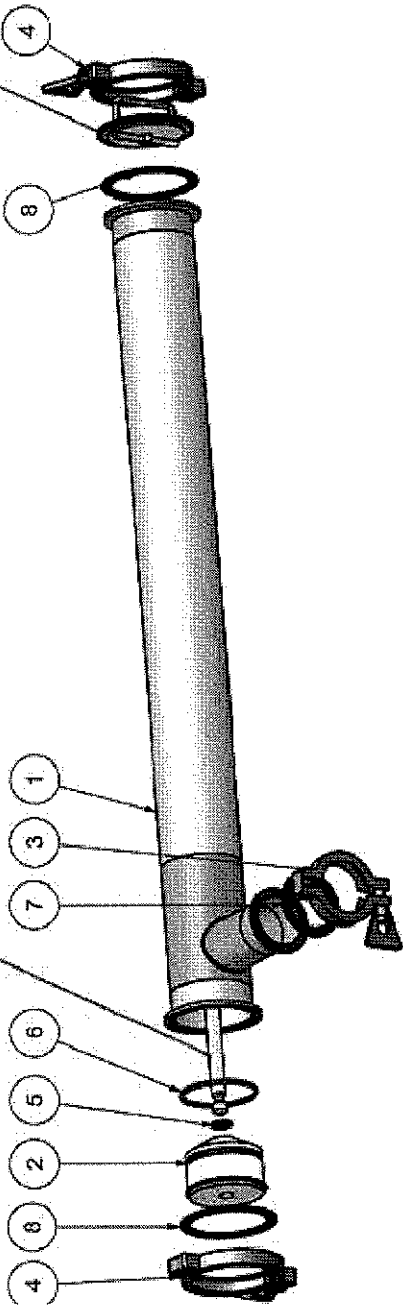
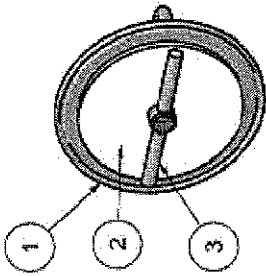

IT.	QTY	PART N°	ORDER FORM
1	1	004001122	
2	1	005001009	
3	1	007007002	
4	2	007007003	
5	1	008001008	
6	1	008001014	
7	1	008003002	
8	2	008003003	

# 3-D SCHEME SPARE PART IDENTIFICATION Belpump-lift

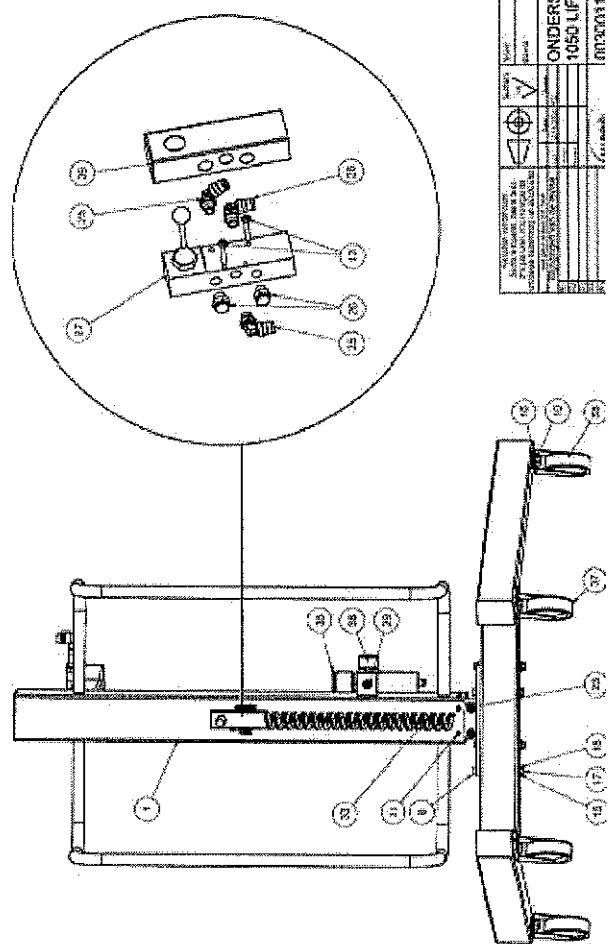
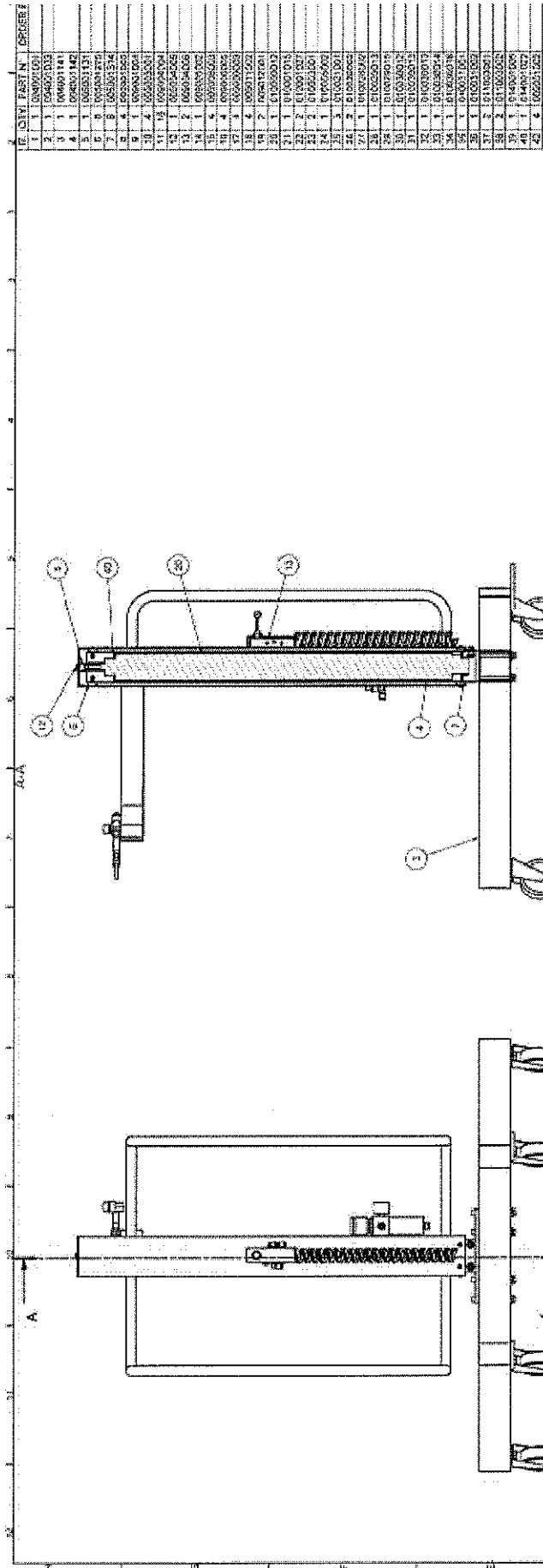

Part No.	Part Name	Quantity
1	SPARE PART IDENTIFICATION	1
2	SPARE PART IDENTIFICATION	1
3	SPARE PART IDENTIFICATION	1
4	SPARE PART IDENTIFICATION	1
5	SPARE PART IDENTIFICATION	1
6	SPARE PART IDENTIFICATION	1
7	SPARE PART IDENTIFICATION	1
8	SPARE PART IDENTIFICATION	1
9	SPARE PART IDENTIFICATION	1
10	SPARE PART IDENTIFICATION	1
11	SPARE PART IDENTIFICATION	1
12	SPARE PART IDENTIFICATION	1
13	SPARE PART IDENTIFICATION	1
14	SPARE PART IDENTIFICATION	1
15	SPARE PART IDENTIFICATION	1
16	SPARE PART IDENTIFICATION	1
17	SPARE PART IDENTIFICATION	1
18	SPARE PART IDENTIFICATION	1
19	SPARE PART IDENTIFICATION	1
20	SPARE PART IDENTIFICATION	1
21	SPARE PART IDENTIFICATION	1
22	SPARE PART IDENTIFICATION	1
23	SPARE PART IDENTIFICATION	1
24	SPARE PART IDENTIFICATION	1
25	SPARE PART IDENTIFICATION	1
26	SPARE PART IDENTIFICATION	1
27	SPARE PART IDENTIFICATION	1
28	SPARE PART IDENTIFICATION	1
29	SPARE PART IDENTIFICATION	1
30	SPARE PART IDENTIFICATION	1
31	SPARE PART IDENTIFICATION	1
32	SPARE PART IDENTIFICATION	1
33	SPARE PART IDENTIFICATION	1
34	SPARE PART IDENTIFICATION	1
35	SPARE PART IDENTIFICATION	1
36	SPARE PART IDENTIFICATION	1
37	SPARE PART IDENTIFICATION	1
38	SPARE PART IDENTIFICATION	1
39	SPARE PART IDENTIFICATION	1
40	SPARE PART IDENTIFICATION	1
41	SPARE PART IDENTIFICATION	1
42	SPARE PART IDENTIFICATION	1

Part No.	Part Name	Quantity
1	SPARE PART IDENTIFICATION	1
2	SPARE PART IDENTIFICATION	1
3	SPARE PART IDENTIFICATION	1
4	SPARE PART IDENTIFICATION	1
5	SPARE PART IDENTIFICATION	1
6	SPARE PART IDENTIFICATION	1
7	SPARE PART IDENTIFICATION	1
8	SPARE PART IDENTIFICATION	1
9	SPARE PART IDENTIFICATION	1
10	SPARE PART IDENTIFICATION	1
11	SPARE PART IDENTIFICATION	1
12	SPARE PART IDENTIFICATION	1
13	SPARE PART IDENTIFICATION	1
14	SPARE PART IDENTIFICATION	1
15	SPARE PART IDENTIFICATION	1
16	SPARE PART IDENTIFICATION	1
17	SPARE PART IDENTIFICATION	1
18	SPARE PART IDENTIFICATION	1
19	SPARE PART IDENTIFICATION	1
20	SPARE PART IDENTIFICATION	1
21	SPARE PART IDENTIFICATION	1
22	SPARE PART IDENTIFICATION	1
23	SPARE PART IDENTIFICATION	1
24	SPARE PART IDENTIFICATION	1
25	SPARE PART IDENTIFICATION	1
26	SPARE PART IDENTIFICATION	1
27	SPARE PART IDENTIFICATION	1
28	SPARE PART IDENTIFICATION	1
29	SPARE PART IDENTIFICATION	1
30	SPARE PART IDENTIFICATION	1
31	SPARE PART IDENTIFICATION	1
32	SPARE PART IDENTIFICATION	1
33	SPARE PART IDENTIFICATION	1
34	SPARE PART IDENTIFICATION	1
35	SPARE PART IDENTIFICATION	1
36	SPARE PART IDENTIFICATION	1
37	SPARE PART IDENTIFICATION	1
38	SPARE PART IDENTIFICATION	1
39	SPARE PART IDENTIFICATION	1
40	SPARE PART IDENTIFICATION	1
41	SPARE PART IDENTIFICATION	1
42	SPARE PART IDENTIFICATION	1

3-D SCHEME SPARE PART IDENTIFICATION Belpump-vario

Onderstel 117R		Onderstel 117R	
1	1	1	1
2	1	2	1
3	1	3	1
4	1	4	1
5	1	5	1
6	1	6	1
7	1	7	1
8	1	8	1
9	1	9	1
10	1	10	1
11	1	11	1
12	1	12	1
13	1	13	1
14	1	14	1
15	1	15	1
16	1	16	1
17	1	17	1
18	1	18	1
19	1	19	1
20	1	20	1
21	1	21	1
22	1	22	1
23	1	23	1
24	1	24	1
25	1	25	1
26	1	26	1
27	1	27	1
28	1	28	1
29	1	29	1
30	1	30	1
31	1	31	1
32	1	32	1
33	1	33	1
34	1	34	1

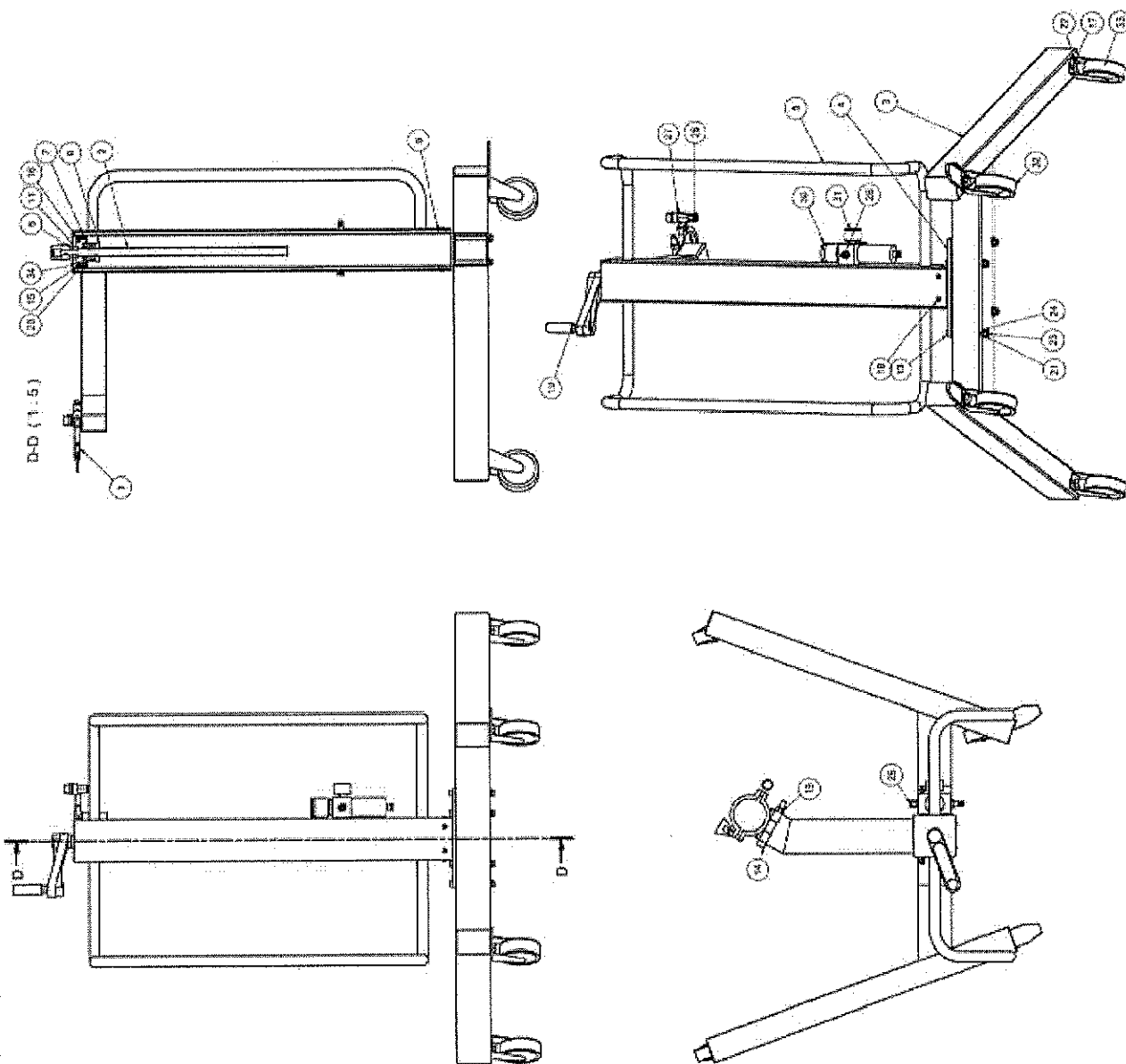

Onderstel 117R		Onderstel 117R	
1	1	1	1
2	1	2	1
3	1	3	1
4	1	4	1
5	1	5	1
6	1	6	1
7	1	7	1
8	1	8	1
9	1	9	1
10	1	10	1
11	1	11	1
12	1	12	1
13	1	13	1
14	1	14	1
15	1	15	1
16	1	16	1
17	1	17	1
18	1	18	1
19	1	19	1
20	1	20	1
21	1	21	1
22	1	22	1
23	1	23	1
24	1	24	1
25	1	25	1
26	1	26	1
27	1	27	1
28	1	28	1
29	1	29	1
30	1	30	1
31	1	31	1
32	1	32	1
33	1	33	1
34	1	34	1