

CK 100

CRATE WASHER



Operator Manual



IMPORTANT

Information supplied in this manual is copyright. No part of this work may be reproduced or copied in any form or by any means, electronic or mechanical without the express permission of the author / publisher.



IMPORTANT

The alteration of machine operation, design or the replacement of parts not approved by the manufacture may void warranties and approvals.

We have checked that the contents of this document correspond to the model described. There may be discrepancies nevertheless, and no guarantee can be given that they are completely identical. The information contained in this document is reviewed regularly and any necessary changes will be included in the next edition. We welcome suggestions for improvement.

Document subject to change without prior notice.



Distributed In
Australia by

MOFFAT®

740 Springvale Road, Mulgrave 3170, Victoria, Tel 03 9518 3888 Fax 03 9518 3818

Service 1 800 622 216
Parts 1 800 337 963

Safety Instructions



WARNING

Equipment contains dangerous voltages and can be hazardous if installed or operated incorrectly. Non-compliance with **Warnings** or failure to follow the instructions contained in this manual can result in loss of life, severe personal injury or serious damage to property.

Installation

- ◆ Use qualified, skilled personnel
- ◆ Follow installation instructions
- ◆ Connect to correct voltage and supply current
- ◆ Provide fully accessible Electrical Isolation Switch

Training and Supervision

- ◆ Read and Understand the Operating instructions
- ◆ Train all staff.
- ◆ This appliance is not intended for use by young children, who must be supervised to ensure they do not play with the appliance.
- ◆ This appliance is not intended for use by infirm persons without supervision
- ◆ This appliance is not intended for use as a stepladder

Hot Surfaces

- ◆ Be aware some surfaces can be hot.

Chemicals

- ◆ Commercial dishwashing detergents are hazardous
- ◆ Read and follow the safety information found on the labels of detergent containers and Material Safety Data Sheets
- ◆ Handle with care
- ◆ Use protective eyewear and clothing if decanting containers

Hot Water

- ◆ Door safety switches are designed for emergency use only.
- ◆ Wait for the green cycle light to go out before opening the door.
- ◆ Wash water is 60°C and contains caustic detergent so DO NOT put hands in wash water.

Cleaning

- ◆ DO NOT hose down the machine or splash water over the exterior.
 - ◆ Watch for broken glass etc when cleaning the inside of the machine.
-

Installation



WARNING

Installation personnel must be suitably qualified and ensure compliance with all codes and standards.



IMPORTANT

Failure to comply (even partially) with the instructions given in this manual will invalidate the product warranty and relieves the manufacturer of any responsibility.

Install machine on sound waterproof self-draining floor and use adjustable feet to level machine. Legs are available to raise machine if required. Allow room for detergent to one side of machine or in adjacent cupboard. 20litre container requires about 450H x 250W x 350D, but smaller containers are available from many suppliers.

Water Supply

Temperature	- 65°C ± 5°C
Pressure	- 200-400 KPa = 30-60 Psi recommended
Consumption	- 300 litres per hour approx.
Connection	- 20 mm (3/4 BSP Male)



IMPORTANT

Flush supply line before connection.
Do not use small diameter plastic supply lines.

Waste

Connection	- 40 mm, direct waste pipe behind machine or through open area in base – see installation diagram on page 6.
------------	--

Power

Electrical supply must be 5 Wires 3 Phase, Neutral and Earth 400/415V 25A 50Hz, permanently wired via wall switch mounted adjacent to machine.

Commissioning Procedures

Connect all services as above. Ensure that all internal components such as filters and drain upstand are in place. Turn on water and switch on power. Close machine door and switch machine on, machine will fill. When water sprays from rinse arms inside machine, switch machine off at wall. Remove lower front panel and switch commissioning switch by breaking label over same. Check rotation of wash pump and alter supply phase connections if necessary to achieve correct rotation. Close panel and switch machine on. Machine is now ready for use – refer operating instructions.

Detergent Pump

Refer your professional chemical supplier for advice on wash and rinse chemicals and dispensers.

Installation Diagram

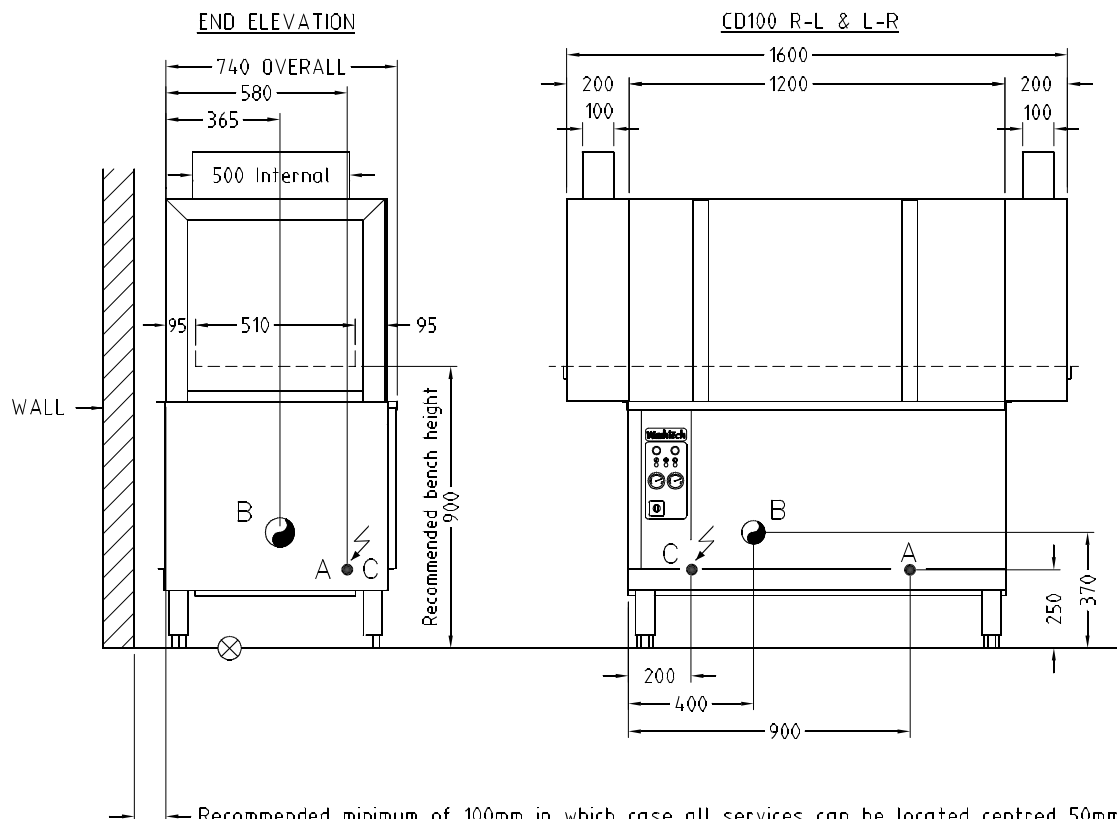
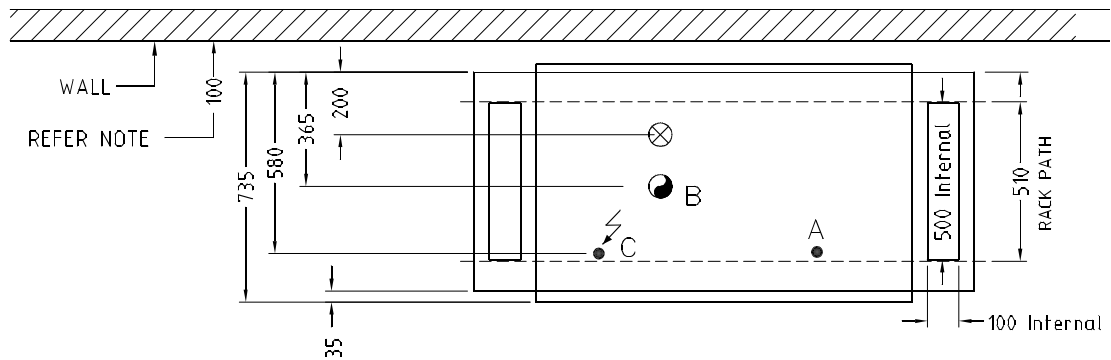

Recommended minimum of 100mm in which case all services can be located centred 50mm off wall, and bench depth = 750mm. Gap to wall may be reduced to 50mm and bench to 700mm but services must then come through floor in adjacent location as shown.

CONNECTIONS			Ø
A	HOT WATER INLET = 65°C	200-400 kPa	3/4"
B	TANK DRAINAGE POINT IS	1.5" BSP =	40mm
	RECOMMENDED MINIMUM WASTE PIPE	2" BSP =	50mm
C	ELECTRICAL CONNECTION 400/415V, 3-N+E~ 50HZ	CD100 =	25A
⊗	SHOWS RECOMMENDED FLOOR PENETRATION. POSITION FOR WASTE AND SUPPLY - IN LINE WITH END ELEVATION		

Operation

Description of Controls

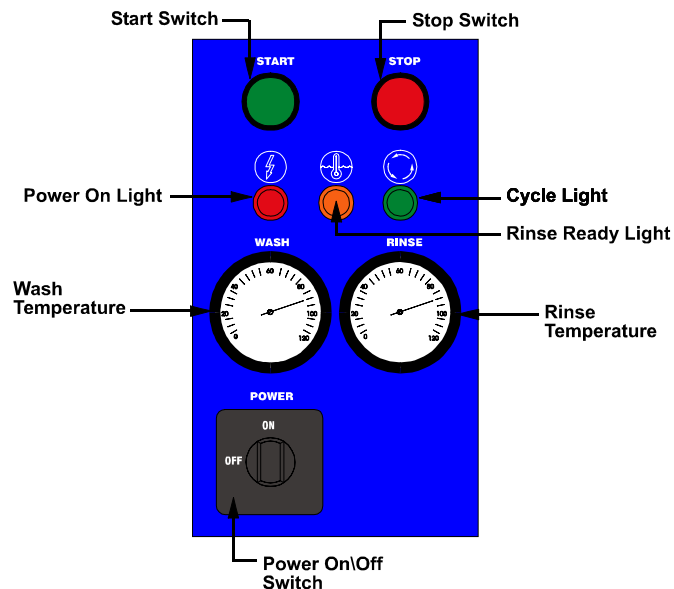

Operating Instructions

Start up

Fit drain upstand, wash pump filter, scrap trays and shut door.
Turn wall and machine power switches on.
Power light glows red and machine fills automatically.
When wash tank is full, filling automatically stops.
Ready light glows amber when the machine is up to required temperature.

Operation

Press Start button to start wash pump operation.
Green Cycle light glows during an operation.
When Ready light is illuminated racks can be fed into the machine.

NOTE: Conveyor will not operate unless amber Ready light is illuminated.

Shut down every night

Press Stop button.
Turn machine and wall power switches off.
Remove scrap trays and rinse clean.
Remove drain upstand to drain wash tank.
Remove wash pump inlet filter and rinse clean.
Replace drain upstand, filter and scrap trays.

Performance

Hot Water Supply

An adequate supply of water at the correct temperature and pressure is essential for effective operation of your machine. Refer Installation information for detail. Water softening is recommended in hard water areas - especially for glasswashing.

Pre-rinsing

Pre-scraping of dishes is required by Food Hygiene Regulations. The best method is to pre-rinse with warm water with a Fisher Pre-rinse Unit - or alternatively by scraping or dunking in water. Cutlery should be pre-soaked in warm water, preferably containing cutlery pre-soak compound - refer your chemical supplier.

Racking Procedures

Do not overload racks or cutlery containers, minimise the overlap of crockery. Cycle times are short and water consumption per cycle low - so there is no advantage in overloading racks.

Cycle Times

For multi-cycle machine use the longest cycle whenever possible. Note that water consumption does not increase with longer cycles. Only switch to faster cycles when it is necessary.

Detergent

Use of correct type and quantity of detergent is essential to the performance of the machine. Low foam specialty products are recommended. We strongly recommend that you use a professional dishmachine chemical supplier - and will be pleased to recommend a supplier in your region. Discuss with them the use of cutlery pre soak solution, detergent and drying agent.

Drying

Single tank commercial dishwashers do not have a drying cycle. However, the machines do rinse at high temperatures which promote fast drying particularly when drying agents are used. We recommend prompt removal of the rack from the machine - leave the rack on the bench for 2 to 3 minutes before emptying. This time will be reduced with correct use of drying agent (rinse fluid) which reduces water surface tension and allows water to drain quickly from wash ware. For advice on drying agents and injectors refer to your chemical supplier.

Daily Cleaning

It is essential that the machine is drained and cleaned at the end of each day. Drain the machine then remove, clean and replace filters as per the operating instructions. Regularly check the wash and rinse jets and clean them if necessary – refer Maintenance section.

Maintenance

Regular Cleaning

1. Remove upstand **1** to drain wash tank. Remove scrap trays **2** and wash pump inlet filter **3**. Clean them with water and a brush to clear grids.
2. Remove wash arms **4** – lift to unhook and then withdraw. Remove rinse arms **5** – twist and withdraw. Flush arms with water using a toothpick or paperclip, if necessary, to clear jets.

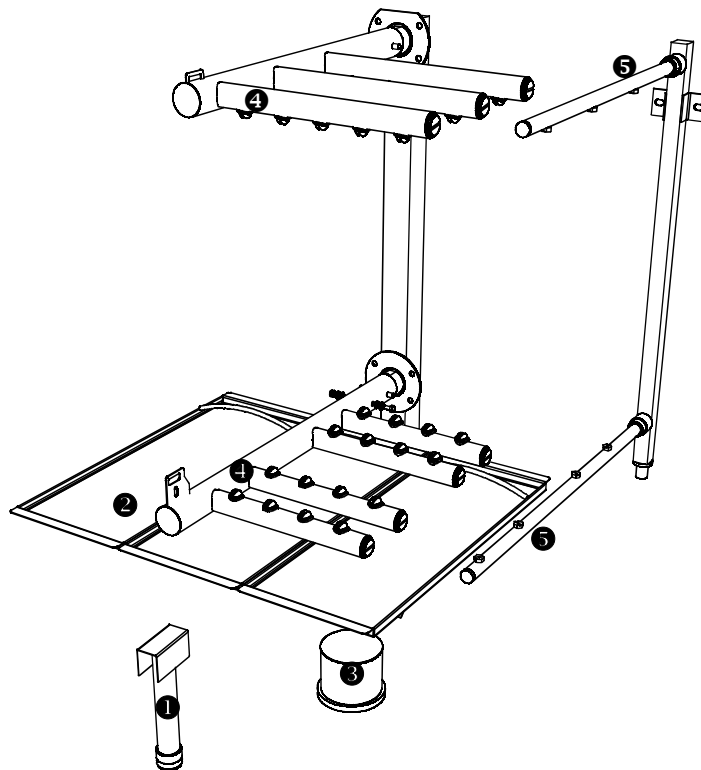

Regular Servicing

Regular servicing of the dishwasher is essential to keep the machine in top working condition and get the best performance results.

Please contact your Service Provider to organize regular servicing of the dishwasher.

CK100 SCHEMATIC DIAGRAM

250167 04/11/05 1A

