

# Convotharm flexx pro Single Pan Electric Multi Pan

## CFXP 201F - 150 LITRE CAPACITY

- 150 litre single pan capacity
- 4 x 1/1 GN pan size
- 83dm<sup>2</sup> cooking surface
- 220mm depth pan
- Multi pan for cooking, frying, braising, grilling, searing, broiling and sous-vide cooking
- Independent automatic arm for lifting / lowering of baskets
- Automatic water filling system with accuracy of 1 decilitre
- Electromechanical tray tilting at variable speed
- 12" colour touch screen with intuitive controls
- Automatic and manual meal preparation mode with memory for 800 programs with 12 steps
- Multipoint core temperature probe
- Integrated retractable hand shower



### Overall Construction

- Base frame with 3mm 304 grade stainless steel
- Frame cover with 304 grade stainless steel
- Tray with 3mm 316 grade stainless steel
- Special sandwich design pan base
- Stainless steel SUPER BLOCK JPX 17 full area heat distribution system
- Robust double insulated cover with automatic lifting function
- Excessive steam exhaust on cover
- Integrated 230V / 16A socket
- Retractable switchboard panel on right pillar allowing integration of multiple pans in a single block

### Controls

- Fast base preheating
- Temperature range from 30°C-250°C
- Accurate sensory measurement of temperature
- Liquid level gauge
- Integrated drainage in the tray bottom with automatic closure
- Preset technological procedures
- Automatic lowering of baskets - allows operation with cover closed
- Safety sensor for basket arm detection
- Fault messages shown on display
- Water pressure controller
- HACCP recording
- USB port for data backup

### Accessories

- Easy clean stainless steel surface
- Easy services access from front and top sides
- Technical and service information on display

# Convotharm flexx pro Single Pan Electric Multi Pan

## CFXP 201F - 150 LITRE CAPACITY

### DIMENSIONS

Width	2009 mm
Depth	850 mm
Height	1050 mm
Weight	490kg

### CAPACITY

150 litre

### PACKED DIMENSIONS

Width	2125 mm
Depth	920 mm
Height	1145 mm
Weight	525kg

### ELECTRICAL SUPPLY

415V, 3P+N+E, 50Hz, 63A

Energy consumption 50.1kW

### WATER CONNECTION

Inlet connection R ¾

Water outlet connection Ø 50

### INSTALLATION CONDITIONS

(for precise installation instructions please refer to our installation manual)

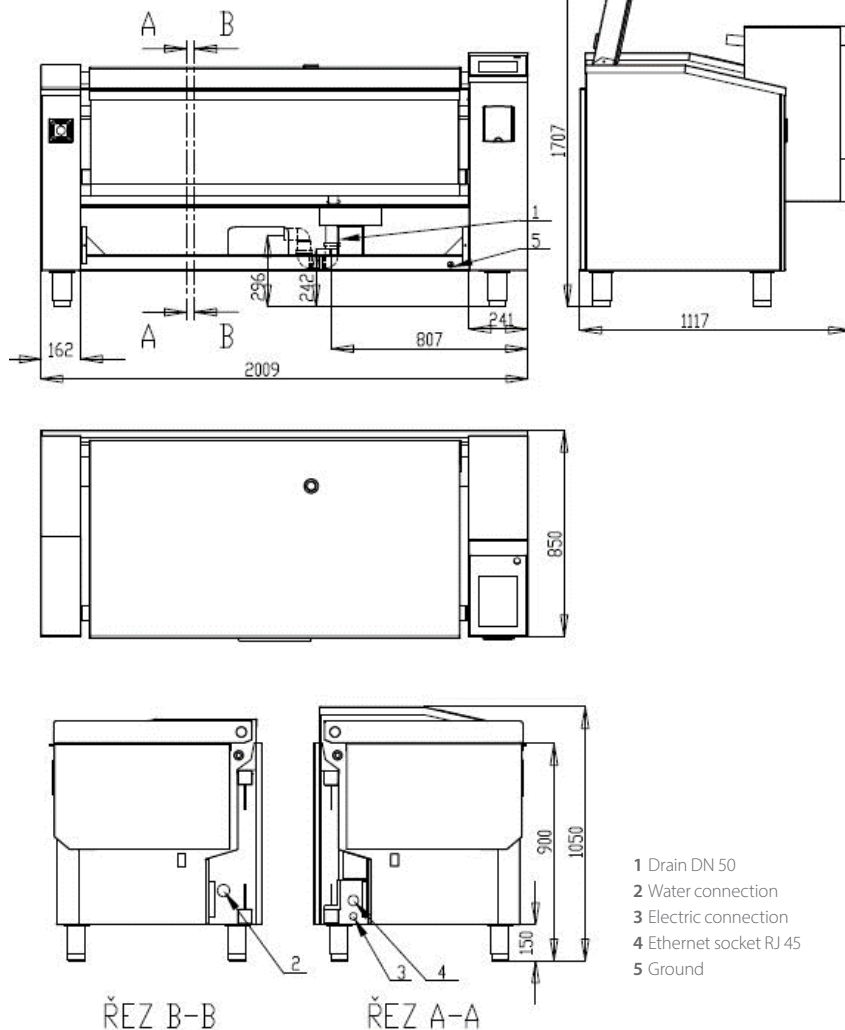

moffat.com.au  
moffat.co.nz

Australia  
moffat.com.au

Moffat Pty Limited

Victoria/Tasmania  
740 Springvale Road  
Mulgrave, Victoria 3170  
Telephone +61 3-9518 3888  
Facsimile +61 3-9518 3833  
vsales@moffat.com.au

New South Wales  
Telephone +61 2-8833 4111  
nswsales@moffat.com.au

South Australia  
Telephone +61 3-9518 3888  
vsales@moffat.com.au

Queensland /  
Northern Territory  
Telephone +61 7-3630 8600  
qldsals@moffat.com.au

Western Australia  
Telephone +61 8-9413 2400  
wasales@moffat.com.au

New Zealand  
moffat.co.nz

Moffat Limited

Rolleston  
45 Illinois Drive  
Izone Business Hub  
Rolleston 7675  
Telephone +64 3-983 6600  
Facsimile +64 3-983 6660  
sales@moffat.co.nz

Auckland  
Telephone +64 9-574 3150  
sales@moffat.co.nz

In line with policy to continually develop and improve its products, Moffat Limited reserves the right to change specifications and design without notice.

© Copyright Moffat Ltd  
AN.CON.S.01.25



an Ali Group Company



The Spirit of Excellence