

Technical data sheet for

## E35T6-30 ON THE SK35 STAND

Full Size Electric Convection Oven

TOUCH SCREEN CONTROL on a Stainless Steel Stand



### E35T6-30

Unit shall be a Moffat electrically heated Turbofan convection oven. The oven shall have a one piece vitreous enameled oven chamber, stainless exterior top and sides. The oven shall have a vented safe touch side hinged door that offers field reversible hinging. Oven shall have capacity for 6 16" x 29" or 18" x 30" trays. The oven shall have selectable steam level injection and a 2 speed oven fan. The oven shall be controlled by a 5.7" Touch Screen control with manual and recipe operating modes with icon driven recipe programs and individual shelf control operation mode and multiple stage cooking. Oven controller shall have USB port for recipe file uploading and downloading. A core temperature probe M236060 is optional. The oven shall include dual halogen oven lamps. The oven shall be able to be bench mounted on 76mm feet or mounted on oven stand model SK35. Unit shall be supplied in 100% recyclable shipping packaging.

### SK35

Unit shall be a Moffat Turbofan stainless steel oven stand. The stand shall be constructed from stainless steel tube with castors, with front castors having dual swivel and wheel locks. It shall be fitted with 6 tray runners suitable for 16" or 18" wide trays. The stand shall be fully compatible with, and support, Turbofan Convection Oven models E35D6 and E35T6. Unit shall be supplied in 100% recyclable shipping packaging.

### STANDARD FEATURES

- 6 406mm x 736mm / 16" x 29" tray capacity
- 6 457mm x 762mm / 18" x 30" tray capacity
- 105mm tray spacing
- 910mm width
- Touch Screen control
- Program and manual modes
- Icon driven program menu
- Multiple stage cooking
- Individual shelf control and shelf timers
- Auto-Start mode
- Energy Save Set-Back mode
- Straight or Flex cooking time
- Core probe cooking (optional Core probe Kit)
- USB port for program/icon updating
- Steam injection mode (5 levels)
- 2 speed bi-directional reversing fan system
- 12kW heating power
- Oven vent - Program and manual control
- Safe-Touch vented side hinged door (standard LH hinge). Optional RH hinge (field convertible)
- Slam-shut / Pendulum door latch
- Vitreous enameled oven chamber
- Push fit continuous oven door seal (no tools)
- Dual halogen oven lamps
- Anti-skid 50mm dia. 76mm high adjustable stainless steel feet
- 6 oven wire racks supplied
- 100% recyclable packaging

### OPTIONS

- Single Phase model (specify when ordering)

### ACCESSORIES

- Optional M236060 Core Temperature Probe Kit
- Turbofan SK35 Oven Stand
- DSK35 Double Stacking Kit

#### E35T6-30 Full Size Convection Oven TOUCH SCREEN CONTROL

##### CONSTRUCTION

Vitreous enameled fully welded oven chamber  
Stainless steel front, sides and top exterior  
Stainless steel oven fan baffle and oven vent  
6 removable position stainless steel side racks  
Oven racks chrome plated wire (6 supplied)  
Stainless steel frame side hinged door  
5mm thick door outer glass  
5mm thick low energy loss door inner glass  
Full stainless steel welded door handle  
Stainless steel control panel  
Aluminised coated steel base and rear panels

##### CONTROLS

5.7" LED backlit touch screen  
Icon driven program menu  
BMP image icon imports via USB port  
Program updates via USB port  
Temperature range 50-260°C  
Adjustable sounder tones and volume  
Other specification on request  
Safety thermostat cut-out  
Optional core temp probe

##### CLEANING

Stainless steel top and side exterior panels  
Vitreous enameled oven chamber  
Fully removable stainless steel oven side racks  
Removable stainless steel oven fan baffle  
Easy clean door system with hinge out door outer glass  
(no tools required)  
Removable push fit oven door seal (no tools required)  
76mm high stainless steel feet for easy access underside

##### SPECIFICATIONS

###### Electrical Requirements

3 phase model  
400-415V, 50Hz, 12.5kW, 3P+N+E, 17.4A / ph  
1 phase model (option)  
230-240V, 50Hz, 12.5kW, 1P+N+E, 52A  
No cordset supplied

###### Water Requirements (optional)

Cold water connection 3/4" BSP male  
80psi maximum inlet pressure / 20psi minimum inlet pressure

###### External Dimensions

Width 910mm  
Height 871mm including 76mm feet  
Depth 1022mm

##### Oven Internal Dimensions

Width 465mm  
Height 710mm  
Depth 800mm  
Volume 0.26m³

##### Oven Rack Dimensions

Width 460mm (18")  
Depth 760mm (30")

Nett Weight (E35T6-30)  
156kg

##### Packing Data (E35T6-30)

195kg  
1.07m³  
Width 950mm  
Height 960mm  
Depth 1170mm

#### SK35 Stainless Steel Stand

All stainless steel welded frame oven stand for Turbofan E35D, E35T Series ovens  
6 position tray runners standard  
76mm diameter wheel swivel castors standard with 2 front castors with dual swivel and wheel  
Welded 38mm and 32mm square tube front and rear frames  
Welded rack supports/side frames  
4 dia. 76mm swivel castors with 2 front castors dual wheel and swivel lock  
Top frame oven supports suit Turbofan E35D, E35T Series oven mounting  
Supplied CKD for assembly on site

##### External Dimensions (SK35 Oven Stand)

Width 910mm  
Height 880mm  
Depth 827mm

Nett Weight (SK35 Oven Stand)  
24kg

##### Packing Data (SK35 Oven Stand)

27kg  
0.13m³  
Width 960mm  
Height 815mm  
Depth 160mm

##### INSTALLATION CLEARANCES

Rear 50mm  
LH Side 50mm  
RH Side\* 50mm  
\* For fixed installations a minimum of 500mm is required for service

##### CLEARANCE FROM SOURCES OF HEAT

A minimum distance of 300mm from the appliance sides is required



##### Australia

[www.moffat.com.au](http://www.moffat.com.au)

##### New Zealand

[www.moffat.co.nz](http://www.moffat.co.nz)

[www.turbofanoven.com](http://www.turbofanoven.com)

##### Australia

##### Moffat Pty Limited

Victoria/Tasmania  
740 Springvale Road  
Mulgrave, Victoria 3170  
Telephone +61 3-9518 3888  
Facsimile +61 3-9518 3833  
vsales@moffat.com.au

##### New South Wales

Telephone +61 2-8833 4111  
[nswsales@moffat.com.au](mailto:nswsales@moffat.com.au)

##### South Australia

Telephone +61 3-9518 3888  
vsales@moffat.com.au

##### Queensland

Telephone +61 7-3630 8600  
[qldsales@moffat.com.au](mailto:qldsales@moffat.com.au)

##### Western Australia

Telephone +61 8-9413 2400  
wasales@moffat.com.au

##### New Zealand

##### Moffat Limited

Christchurch  
45 Illinois Drive  
Izone Business Hub  
Rolleston 7675  
Telephone +64 3-983 6600  
Facsimile +64 3-983 6660  
[sales@moffat.co.nz](mailto:sales@moffat.co.nz)

##### Auckland

Telephone +64 9-574 3150  
[sales@moffat.co.nz](mailto:sales@moffat.co.nz)



Designed and manufactured by



##### ISO9001

All Turbofan products are designed and manufactured by Moffat using the internationally recognised ISO9001 quality management system, covering design, manufacture and final inspection, ensuring consistent high quality at all times.

In line with policy to continually develop and improve its products, Moffat Limited reserves the right to change specifications and design without notice.

© Copyright Moffat Ltd  
AN.TFN.S.2601

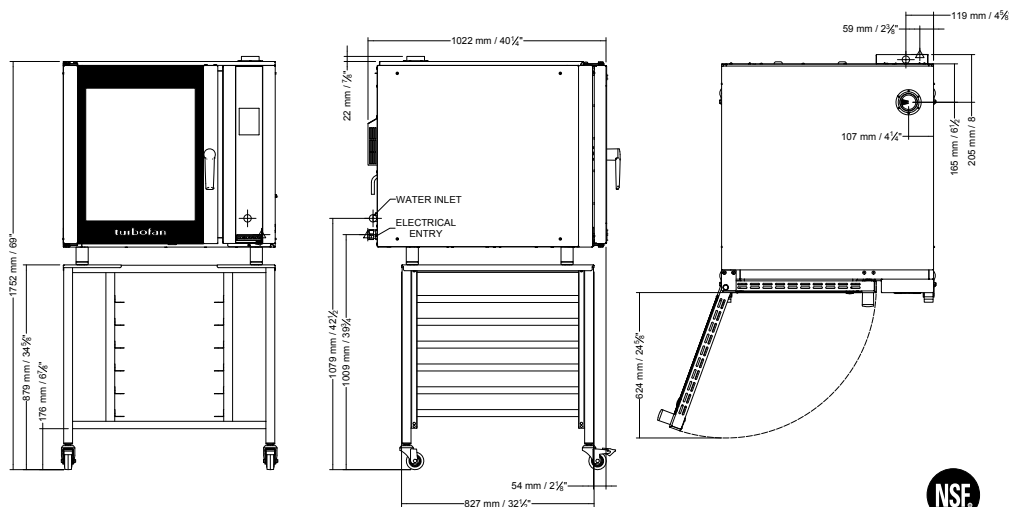

an Ali Group Company



The Spirit of Excellence