

# ELECTRIC SOLID TOP 900mm -

E57-B, E57-LS, E57-CB, E57-RB

- Heavy-duty construction
- 10.8kW solid hot plate
- 750mm x 570mm cooking area
- Four independent heating zones (2.7kW)
- 16mm thick 16Mo3 chrome moly steel plate
- 3 models of base unit
- 1 model of refrigerated base with two GN 1/1 drawers
- Rear rollers
- Stainless steel exterior
- Easy clean
- Easy service
- Fully modular



E57-LS

## Overall Construction

### Cooktop

- Welded hob with one-piece formed 2.0mm 304 stainless steel top
- Side panels 1.2mm 304 stainless steel
- Splashback 1.2mm 304 stainless steel
- Vitreous enamelled control panel
- 16mm thick 16Mo3 chrome moly steel
- Four radiant heating elements under plate
- Four independent heating zones
- Aluminised steel internal construction

### Bench mount (supplied as -B model)

- Four 63mm dia. heavy-duty 1.2mm 304 stainless steel bench legs with adjustable feet
- Adjustable height 80mm – 105mm

### Leg Stand (supplied as -LS model)

- Fully modular for matched suite finish
- Framed top for connection to Cooktop
- 63mm dia. heavy-duty 1.2mm 304 stainless steel legs with two adjustable feet at front and two rollers at rear
- Fully modular framed stand shelf with 0.9mm 304 stainless steel finish
- Quick assembly design

### Cabinet Base (supplied as -CB model)

- Fully modular for match suite finish
- Double skin 0.9mm 304 stainless steel interior and exterior
- Optional GN 1/1 4 position racking kit
- 63mm dia. heavy-duty 1.2mm 304 stainless steel legs with two adjustable feet at front and two rollers at rear

## Refrigerated Base (supplied as -RB model)

- Self contained suite matched modular base
- Ventilated system with R290 refrigerant
- -2 to +8°C temperature (Tropical Climate rated)
- Two GN 1/1 drawers
- 100mm deep pan capacity
- Heavy-duty European telescopic drawer guides
- Magnetic drawer gaskets (replaceable without tools)
- 50mm fully foamed CFC free insulation
- 304 stainless steel exterior and interior
- Anti-corrosion treated evaporator
- No condensate drain required
- 63mm dia. heavy-duty 1.2mm 304 stainless steel legs with adjustable feet
- Condensing unit removable through front of unit for service
- Easy clean interior

## Controls

### Cooktop

- Large easy use control knob - heat resistant reinforced
- Easy view control settings on knob
- Four 6 position switches for heating zones temperature control
- Power indicator light for each element control

### Refrigerated Base

- Digital control electronic thermostat
- Automatic defrost
- Automatic evaporation of defrost water
- -2 to +8°C temperature range

## Cleaning and Servicing

- All models with easy clean stainless steel external finish
- Removable stainless steel spill tray
- Access to all parts from front of unit
- Refrigerated Base condenser removable through front of unit

# ELECTRIC SOLID TOP 900mm -

E57-B, E57-LS, E57-CB, E57-RB

**Specifications**

**Cooktop**

16mm thick 16Mo3 steel hot plate  
750mm x 520mm plate area.  
Four 2.7kW radiant heating elements under plate

**Electrical requirements**

**E574**

10.8kW, 400-415Vac, 50/60Hz, 3P+N+E,  
L1 22.5A, L2 13A, L3 13A

**Refrigerated Base**

**Type**

Ventilated system

**Refrigerant**

R290 (80grams)

**Climate classification**

T - tropical

**Electrical connection**

220-240Vac, 50Hz, 1.8A, 1P+N+E  
3 pin plug 10A cordset fitted

**Dimensions**

**Bench models**

Width 900mm  
Depth 812mm  
Height 315mm  
Incl. splashback 485mm

**All models (excluding Bench model)**

Width 900mm  
Depth 812mm  
Height 915mm  
Incl. splashback 1085mm

**Nett weight**

**Bench and Leg Stand models**  
90kg

**Cabinet Base and Refrigerated Base models**  
130kg

**Packing data**

**Bench and Leg Stand models**  
0.55m<sup>3</sup>, 135kg  
Width 945mm  
Depth 870mm  
Height 665mm

**Cabinet Base and Refrigerated Base models**  
1.03m<sup>3</sup>, 195kg  
Width 945mm  
Depth 870mm  
Height 1255mm

**Options**

Adjustable feet at rear

**E57-B**

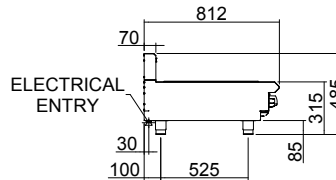
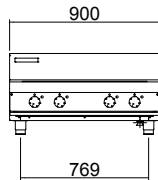

**E57-LS**

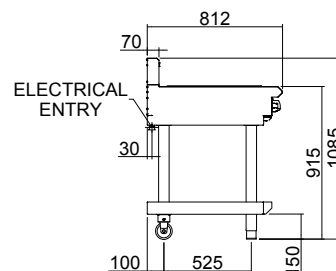
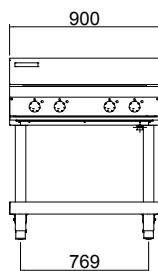

**E57-CB**

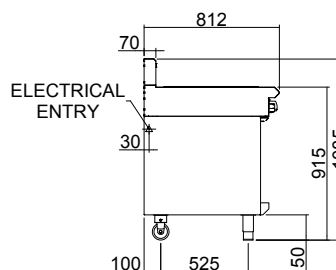
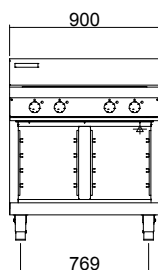

**E57-RB**

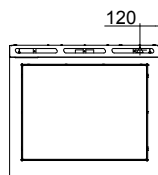
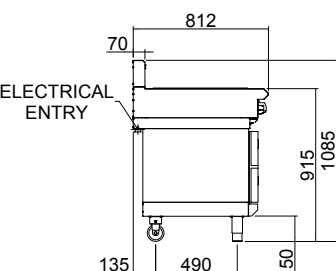
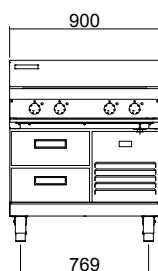

[www.blue-seal.co.uk](http://www.blue-seal.co.uk)

United Kingdom  
[blue-seal.co.uk](http://blue-seal.co.uk)

**Blue Seal Limited**  
Unit 67  
Gravelly Business Park  
Gravelly  
Birmingham B24 8TQ  
England  
Telephone 0121-327 5575  
Facsimile 0121-327 9711  
[sales@blue-seal.co.uk](mailto:sales@blue-seal.co.uk)

**Australia**  
[moffat.com.au](http://moffat.com.au)  
**Moffat Pty Limited**  
740 Springvale Road  
Mulgrave  
Victoria 3170  
Australia  
Telephone +613-9518 3888  
Facsimile +613-9518 3833  
[vsales@moffat.com.au](mailto:vsales@moffat.com.au)

**New Zealand**  
[moffat.co.nz](http://moffat.co.nz)  
**Moffat Limited**  
45 Illinois Drive  
Izone Business Hub  
Rolleston 7675  
New Zealand  
Telephone +64 3-983 6600  
Facsimile +64 3-983 6660  
[sales@moffat.co.nz](mailto:sales@moffat.co.nz)

**International**  
[moffat.com](http://moffat.com)  
[international@moffat.co.nz](mailto:international@moffat.co.nz)



Designed and manufactured by



ISO9001  
All Blue Seal products are designed and manufactured by Moffat using the internationally recognised ISO9001 quality management system, covering design, manufacture and final inspection, ensuring consistent high quality at all times.

In line with policy to continually develop and improve its products, Moffat Limited reserves the right to change specifications and design without notice.



an Ali Group Company



The Spirit of Excellence