

# M2

## PASSTHROUGH DISHWASHER

# WASHTECH®



### STANDARD FEATURES

- 60, 120 and 180 second cycles
- Wash capacity of up to 1,080 plates per hour
- Compatible with 595mm to 640mm benchgaps
- Touchscreen controls with versatile Heads Up Display
- 1.0HP soft start wash pump
- Dual chemical pumps
- Assured rinse with break tank and booster pump
- Hands-free drainage system with sump and drain pump
- Two-stage stainless steel wash and drain filtration
- Heavy-duty stainless-steel construction and manifold
- Independent stainless-steel arms
- Updatable power options for rapid rinse recovery

- 1x 500mm dish rack (600 70028)
- 1x 500mm cup rack (600 70029)
- 1x cutlery container (C660503)
- 1x quick connection kit (all hoses and 1p/15A plugset)

### SPECIFICATIONS

#### A - Hot Water

Temperature	65°C*
Connection	3/4" male, hose supplied
Pressure	100-500kPa
Flow	10L per minute
Backflow prevention	Atmospheric vacuum breaker
Consumption	2.4L per cycle

#### D - Drainage

Drain pump flexi-hose	25mm
-----------------------	------

C - Electrical	V	Hz	A/ph	Max kW
Single phase	230-240	50	15	3.75
Three phase	400-415	50	15	9.00

\*Suitable for connection to low inlet water temp, flow and/or pressure supplies.  
Isolating switch must be within 1m of, and not directly behind, the machine  
Refer to operator manual for installation instructions

In line with policy to continually develop and improve its products, Washtech reserves the right to change specifications and design without notice.

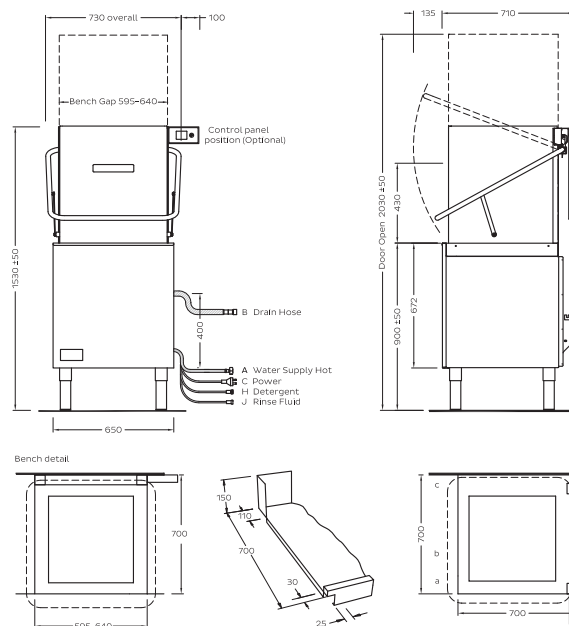

#### Dimensions

	Machine	Packed
Width (mm)	730	760
Depth (mm)	710	820
Height (mm)	1530	1460
Weight (kg)	94	125
Volume (m3)		0.91

#### Water Quality

	Min	Max
pH	7	8
TDS	1	135
Cl-		100
SO4		400
Fe		0.1
Mn		0.5
Cu		0.05
Cl2		0.1

#### Corner Installation Notes:

- Machine should be installed so racks are pushed into the back of the machine.
- Allow 300mm clearance to front for service access.
- Splashback return to be no higher than 150mm.

#### Touchscreen Control:

- Bracket supplied with controls enables install either side, under bench or on wall.
- Consult Operator Manual for full details on correct installation.



moffat.com.au | 1300 269 801



an Ali Group Company



the spirit of excellence