

# ICEMATIC MARACUJA SERIES

MODULAR ICE MAKER  
**MC145F | MC145H**

TECHNICAL SPECIFICATION SHEET FOR

## Icematic Modular Ice Maker

**MC145F - Full Dice** W 22mm x D 22mm x H 24mm, 10g

**MC145H - Half Dice** W 10mm x D 29mm x H 24mm, 6g



- Full dice (F model) or half dice (H model) sized ice cube machine head only
- **134kg** daily production rate
- **168** full dice ice cubes per cycle
- **265** half dice ice cubes per cycle
- **6 litres** per hour water consumption
- Air cooled condensing unit
- R290 propane refrigerant gas
- Vertical evaporator with circulation pump
- Front baffle with microswitch that stops the machine when bin is full
- Electronic control panel with LED showing proper functioning or warning indicators
- Stainless steel external body
- Moffat TA13-NZ filter kit, including head and fittings
- Requires storage bin model SB105, SB155, SB205\*, SB255\*

\*Cover kit KM 205-255 required to suit with storage bins SB205 and SB255

Note: Ice production rate is measured with the water temperature at 10°C and an ambient temperature of 21°C.

# ICEMATIC MARACUJA SERIES

## MODULAR ICE MAKER MC145F | MC145H

### TECHNICAL SPECIFICATION SHEET FOR Icematic Modular Ice Maker MC145F | MC145H

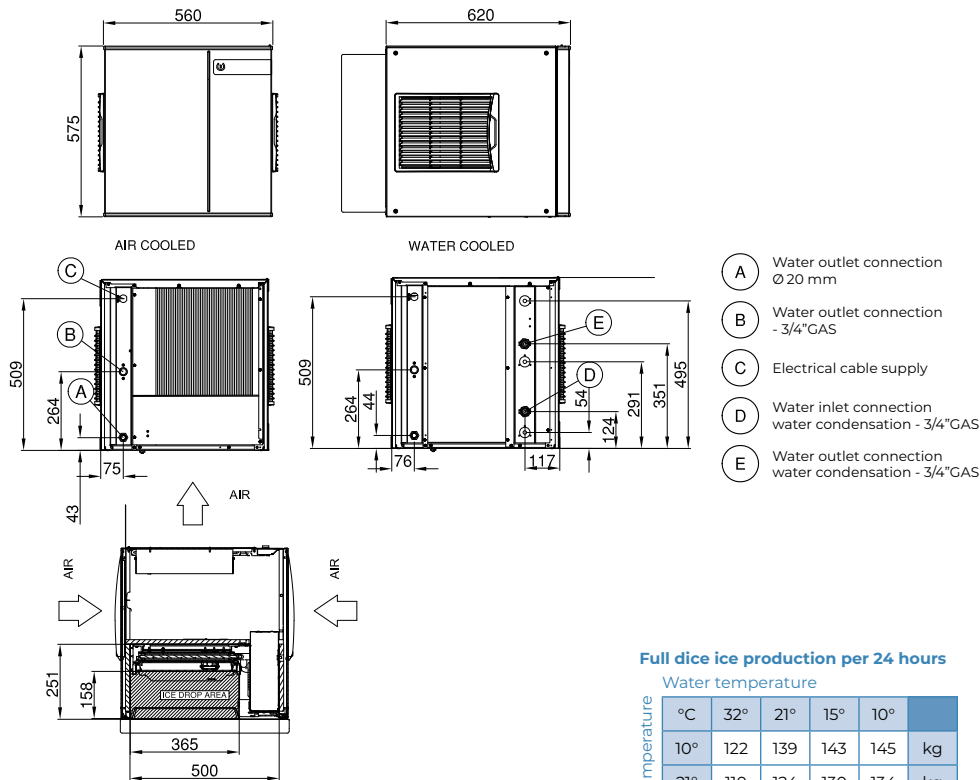

#### Full dice ice production per 24 hours

		Water temperature				
		32°	21°	15°	10°	
Ambient temperature	10°	122	139	143	145	kg
	21°	110	124	130	134	kg
	32°	95	106	108	111	kg
	38°	81	89	96	99	kg

### MC145F | MC145H

#### Dimensions

Width: 560mm  
Height: 575mm  
Depth: 620mm  
Nett weight: 53kg  
Packed weight: 65kg

#### Ice cube production dimension

Full dice: W 22mm x D 22mm x H 24mm, 10g  
Half dice: W 10mm x D 29mm x H 24mm, 6g

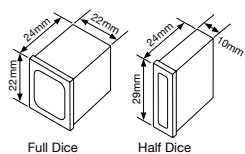

#### Water consumption

Air cooled condensing unit:  
6 litres per hour

#### Electrical rating

220-240V, 1P+N+E, 50Hz  
Compressor power rating  
1967W  
Total absorbed power 650W  
10A cordset fitted

#### Refrigerant type

R290

#### Installation distance from wall

- rear 150mm
- right 150mm
- left 150mm

Placement of unit should be indoors in an environment that does not exceed the air and water temperature limitations of the unit

#### Water connection requirements

Inlet connection: R 3/4"  
Cold water (5-35°C)  
Pressure (1-5 bar)  
Water outlet connection:  
Ø 20mm

**Note:** 3m radius to any source of flame, combustion material or explosive material and ensure sufficient air circulation.



moffat.co.nz

New Zealand  
Moffat Limited  
Christchurch  
45 Illinois Drive  
Rolleston  
Christchurch 7675  
Telephone 03-983 6600  
Facsimile 03-983 6660  
sales@moffat.co.nz  
Auckland  
Telephone 09-574 3150  
sales@moffat.co.nz

Disclaimer:  
All unit capacities are based on subjective testing. Moffat accepts no liability for production values.

In line with policy to continually develop and improve its products, Moffat Limited reserves the right to change specifications and design without notice.



© Copyright Moffat Ltd  
NZ.ICES.2301



an Ali Group Company



The Spirit of Excellence