

TECHNICAL SPECIFICATION SHEET FOR

Icematic Modular Ice Maker

MC305F - Full Dice W 22mm x D 22mm x H 24mm, 10g

MC305H - Half Dice W 10mm x D 29mm x H 24mm, 6g

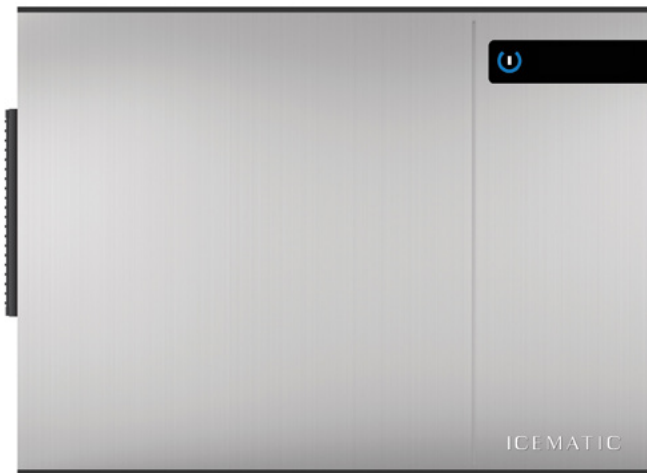

- Full dice (F model) or half dice (H model) sized ice cube machine head only
- **248kg** daily production rate
- **234** full dice ice cubes per cycle
- **370** half dice ice cubes per cycle
- **11.6 litres** per hour water consumption
- Air cooled condensing unit
- R290 propane refrigerant gas
- Vertical evaporator with circulation pump
- Front baffle with microswitch that stops the machine when bin is full
- Electronic control panel with LED showing proper functioning or warning indicators
- Stainless steel external body
- Moffat TA13-NZ filter kit, including head and fittings
- Requires storage bin model SB205, SB255, SB305*, SB405*, SB500, SB700

*Cover kits required to suit with storage bins as follow: KM 305 for SB305, KFM 405 for SB405

Note: Ice production rate is measured with the water temperature at 10°C and an ambient temperature of 21°C.

ICEMATIC MARACUJA SERIES

MODULAR ICE MAKER MC305F | MC305H

TECHNICAL SPECIFICATION SHEET FOR Icematic Modular Ice Maker MC305F | MC305H

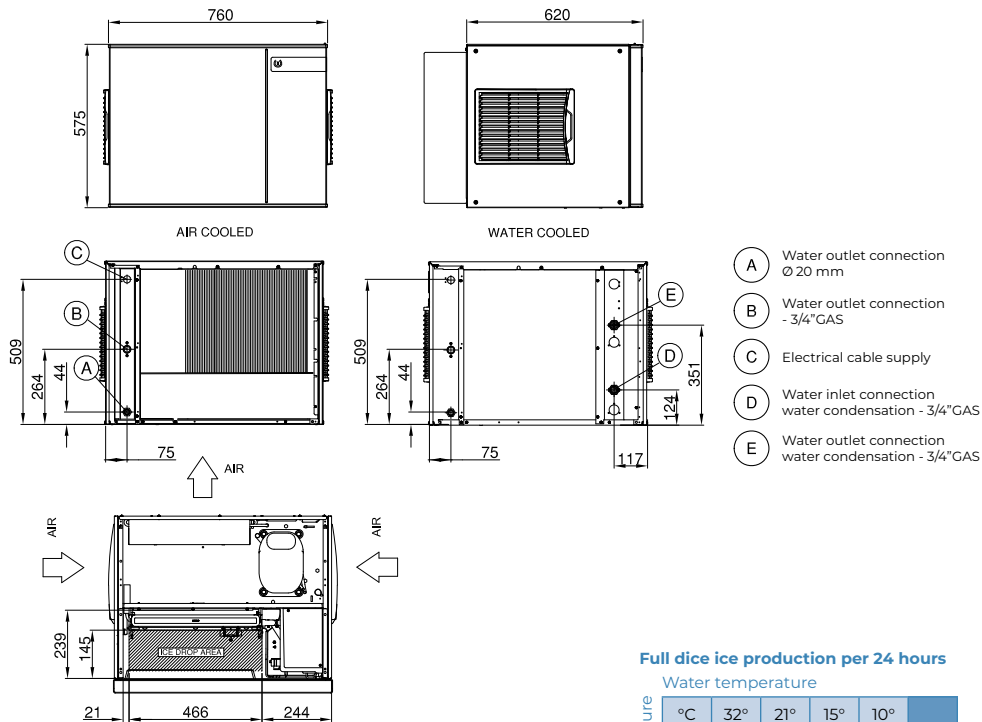

moffat.co.nz

New Zealand
Moffat Limited
Christchurch
45 Illinois Drive
Rolleston
Christchurch 7675
Telephone 03-983 6600
Facsimile 03-983 6660
sales@moffat.co.nz

Auckland
Telephone 09-574 3150
sales@moffat.co.nz

MC305F | MC305H

Dimensions

Width: 760mm
Height: 575mm
Depth: 620mm
Nett weight: 71kg
Packed weight: 86kg

Ice cube production dimension

Full dice: W 22mm x D 22mm x H 24mm, 10g
Half dice: W 10mm x D 29mm x H 24mm, 6g

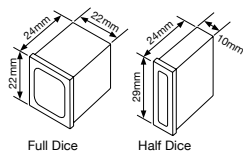

Water consumption

Air cooled condensing unit:
11.6 litres per hour

Electrical rating

220-240V, 1P+N+E, 50Hz
Compressor power rating
1923W
Total absorbed power 1250W
15A cordset fitted

Refrigerant type

R290

Installation distance from wall

- rear 150mm
- right 150mm
- left 150mm

Placement of unit should be indoors in an environment that does not exceed the air and water temperature limitations of the unit

Water connection requirements

Inlet connection: R 3/4"
Cold water (5-35°C)
Pressure (1-5 bar)
Water outlet connection:
Ø 20mm

Note: 3m radius to any source of flame, combustion material or explosive material and ensure sufficient air circulation.



Disclaimer:
All unit capacities are based on subjective testing. Moffat accepts no liability for production values.

In line with policy to continually develop and improve its products, Moffat Limited reserves the right to change specifications and design without notice.



© Copyright Moffat Ltd
NZ.ICES.2301



an Ali Group Company



The Spirit of Excellence