

RS1 - RS2G RS1 SCA INX

RANCILIO SPECIALTY RS1 2 GROUP



STANDARD FEATURES

- 4.3' touchscreen individual group head with dedicated display
- Stainless steel group head multi-boiler system provides outstanding temperature stability
- Advanced temperature profiling allows baristas to unlock the flavour potential of each blend
- Pre-infusion and post-infusion barista has control over the water pressure of the extraction process
- Cool touch steam wands ensure easy manoeuvrability safe operation
- Programmable Timer function will drain and auto renew steam boiler water daily
- ABM advanced boiler management for outstanding steam pressure control and recovery
- Barista LED lighting provides maximum visibility for your coffee extraction and drip tray
- Easy fix technology provides accurate technical info for efficient troubleshooting
- Low profile body designed to maximise customer interaction and service operations
- Two USB ports for simple transfer of machine parameters and to charge any USB device
- Soft touch weight balanced Ergonomic portafilter holder for comfortable all-day operation
- X-Tea program water dosages and temperature levels via the interface
- Multifunction onboard computer and USB port for simple programming and data transfer
- Independent water pump and steam pressure control gauges keep you in control
- Built-in volumetric rotary vane water pump for simple and safe installation

OVERALL CONSTRUCTION

- Hand rolled copper steam boiler - 11 litre capacity
- Stainless steel group head multi boilers
- Fully insulated boiler saves up to 20% energy in standby mode
- Brushed stainless steel exterior panels can be easily removed for customisation

CONTROLS

- Backlit keypads with 4 programmable drink doses and purge or free flow function
- Variable steam lever features purge function and two programmable pressure settings
- Dual hot water buttons can be independently programmed for dose and temperature

CLEANING AND MAINTENANCE

- Stainless steel drip tray - dishwasher safe
- Easy Clean manages the cleaning process of group heads to perform automatically
- Grid system removable cup tray grids keeps work area clean and dishwasher safe
- Rubber blind filter cleaning disc supplied
- Genuine cleaning products sold separately

MATCHING PRODUCTS



RANCILIO SPECIALTY
RS1 3 GROUP



CLASSE 5 USB
TALL 1 GROUP



CLASSE 5 USB
TALL 2 GROUP COMPACT



CLASSE 5 USB
TALL 3 GROUP



CLASSE 7 USB
TALL 2 GROUP



CLASSE 7 USB
TALL 3 GROUP



KYRO EVO

RS1 - RS2G RS1 SCA INX

RANCILIO SPECIALTY RS1 2 GROUP

TECHNICAL INFORMATION

Dimensions

Width:	840mm
Depth:	600mm
Height:	512mm
Nett weight:	95kg
Boiler Capacity:	11 litres

ELECTRICAL

Power requirements: 240V, 1P+N+E,
50/60Hz, 5.6kW, 25A cordset fitted
Boiler Power: 4750W



RANCILIO WATER SPECIFICATION

Optimum Parameter	Measurement Range
	Never more than 50 PPM more than to Total Hardness
TDS <135	
Carbonate Hardness 50 ppm	40-90 ppm
Total Hardness 85 ppm	50-100 ppm
pH (ideal) 7	6.5 – 8.5
Chlorides Cl -	< 30 ppm

WATER CONNECTIONS AND DRAINS

Connection point: Mains cold water - 3/8" BSP

Flow pressure: 30-707 PSI

Drain: open gravity-drain with minimum 50mm/2" LD within 101mm/4of the machine

Hardness: 2-3 GPG (1 grain of hardness = 171 ppm)

Water Quality: Water entering the machine should have a water hardness level of 2-3 GPG at all times.

Always refer to installation manual

INSTALLATION CLEARANCE

- Allow 152.4mm / 6" clearance on all sides of the machine.
- Allow 609mm x 127mm / 24" x 5" for in-line filter. Filter can be mounted behind the machine or under the counter.
- Allow a minimum of 3" (762 mm) clear space under filter to facilitate filter change.
- All services to be within 1m of machine placement



Australia

www.moffat.com.au

New Zealand

www.moffat.co.nz

Australia

Moffat Pty Limited

Victoria/Tasmania

740 Springvale Road

Mulgrave, Victoria 3170

Telephone +61 3-9518 3888

Facsimile +61 3-9518 3833

vsales@moffat.com.au

New South Wales

Telephone +61 2-8833 4111

nswsales@moffat.com.au

South Australia

Telephone +61 3-9518 3888

vsales@moffat.com.au

Queensland

Telephone +61 7-3630 8600

qldsales@moffat.com.au

Western Australia

Telephone +61 8-9413 2400

wasales@moffat.com.au

New Zealand

Moffat Limited

Christchurch

45 Illinois Drive

Izone Business Hub

Rolleston 7675

Telephone +64 3-983 6600

Facsimile +64 3-983 6660

sales@moffat.co.nz

Auckland

Telephone +64 9-574 3150

sales@moffat.co.nz



In line with policy to continually develop and improve its products, Moffat Limited reserves the right to change specifications and design without notice.

© Copyright Moffat Ltd
AN.RAN.2301

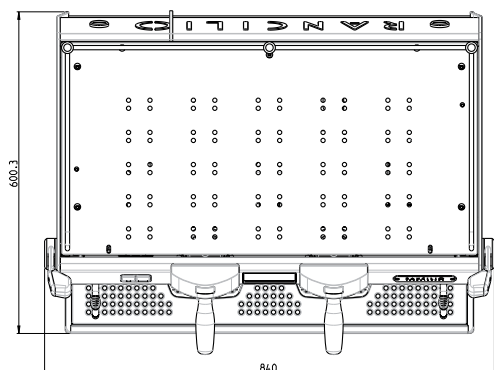
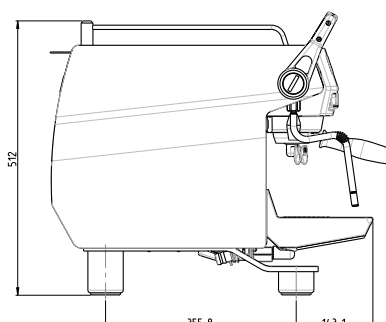
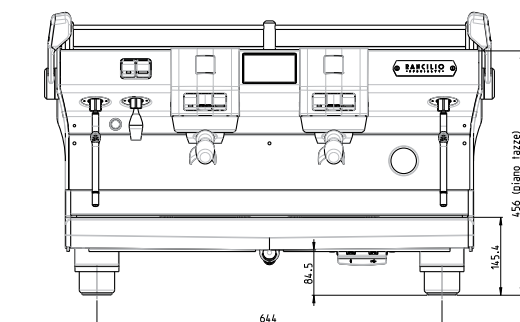

Specifications may vary between models

an Ali Group Company



The Spirit of Excellence